

| ITEM NUMBER | P/N        | DESCRIPTION  | QTY | SPQ |
|-------------|------------|--|-----|-----|
| 1           | 1728652500 | MPC D1 MALE DISPOSABLE HOUSING 17 CKT W/ PAD PRINT | 1   | 10  |
| 2           | 1728674000 | MPC D1 MALE DISPOSABLE BOOT 2.8mm MAX CABLE OD     | 1   | 10  |

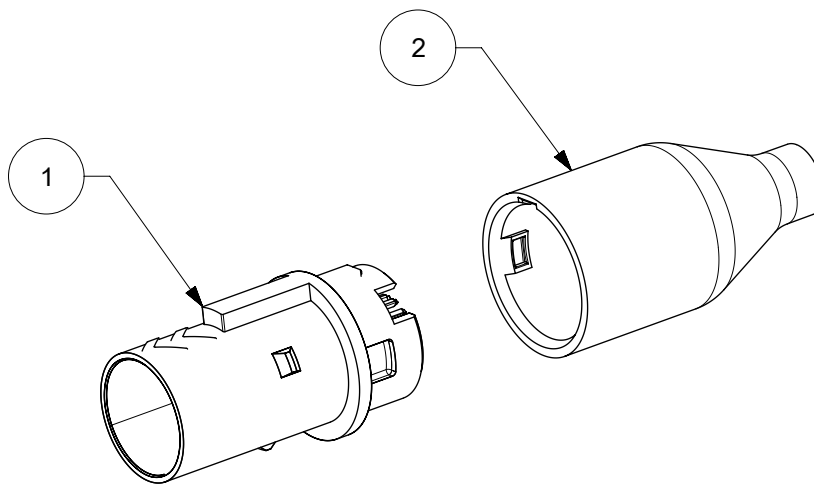
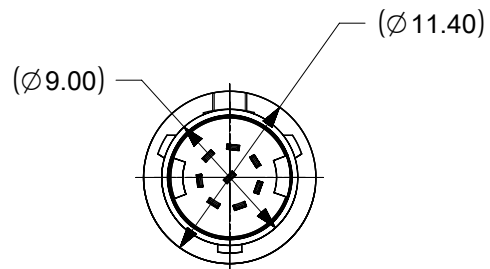
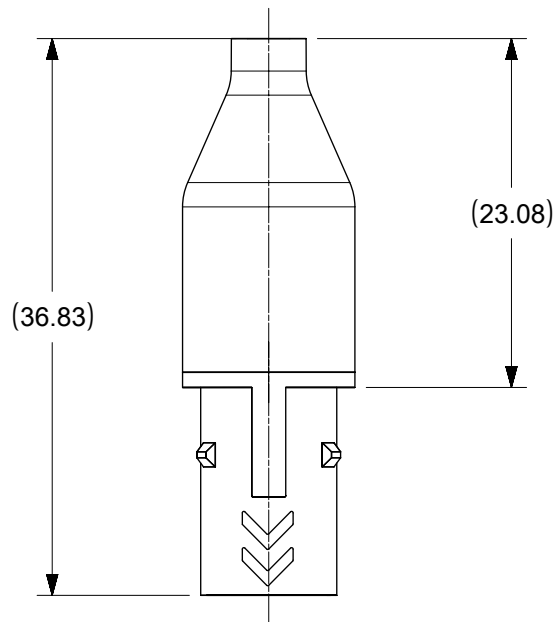

NOTES:

1. KIT TO BE PACKAGED PER SPEC PK-70873-3345
2. MATERIAL, MEDICAL GRADE LEXAN; COLOR, BLACK
3. MATES WITH KIT P/N 203020-08\*0, 172860-08\*0 OR 202405-08\*0.
4. FOR ASSEMBLY INFORMATION SEE APPLICATION SPEC AS-202110-0000.
5. FOR FURTHER PRODUCT INFORMATION SEE PRODUCT SPEC PS-202110-0000

THIS DRAWING CONTAINS INFORMATION THAT IS PROPRIETARY TO MOLEX ELECTRONIC TECHNOLOGIES, LLC AND SHOULD NOT BE USED WITHOUT WRITTEN PERMISSION

|  |                          |                                       |                          |                 |  |
|--|--------------------------|---------------------------------------|--------------------------|-----------------|--|
| EC NO: 114244<br>DRWN: JJONIAK<br>CHKD:<br>APPR: BPISZCZOR | 2017/03/07<br>2017/03/14 | GENERAL TOLERANCES (UNLESS SPECIFIED) | DIMENSION UNITS          | SCALE           | <b>molex</b><br><br>MPC D1 MALE DISPOSABLE 8CKT ASSY KIT |
|  |                          | ANGULAR TOL ± °                       | MM                       | 2:1             |  |
|  |                          | 4 PLACES ±                            | DRWN BY                  | DATE            |  |
|  |                          | 3 PLACES ±                            | JJONIAK                  | 2017/03/07      |  |
| 2 PLACES ±   | CHK'D BY                 | DATE                                  | PRODUCT CUSTOMER DRAWING |                 |  |
| 1 PLACE ±  | APPR BY                  | DATE                                  | SERIES                   | MATERIAL NUMBER | CUSTOMER   |
| 0 PLACES ±   | BPISZCZOR                | 2017/03/14                            | 173250                   | 1732500810      | GENERAL MARKET   |
| DRAFT WHERE APPLICABLE MUST REMAIN WITHIN DIMENSIONS       | DRAWING SIZE             | THIRD ANGLE PROJECTION                | DOCUMENT NUMBER          |                 |  |
|  | B                        |                                       | 1732500810-SD            | DOC TYPE        | DOC PART   |
|  |                          |                                       |                          | PSD             | 000  |
|  |                          |                                       |                          |                 | SHEET NUMBER   |
|  |                          |                                       |                          |                 | 1 OF 1   |