

Flush-type connector - SACC-E-M12FST-4CON-M16/0,5 - 1424138

Please be informed that the data shown in this PDF Document is generated from our Online Catalog. Please find the complete data in the user's documentation. Our General Terms of Use for Downloads are valid (<http://phoenixcontact.com/download>)



Flush-type connector, Power, 4-position, Socket, M12, T power, Front mounting, M16 x 1.5, Individual wires, cable length: 0.5 m

Why buy this product

- For compact devices: transmit high power in a confined space
- Pre-assembled with litz wires for immediate use
- Customer-specific assemblies and litz wire lengths available
- Sealed on the litz wire side for optimum leak-tightness
- For high transmission safety: shield connection to the housing with optional EMC nut



Key Commercial Data

| | |
|--------------|---------------|
| Packing unit | 1 STK |
| GTIN | |
| GTIN | 4046356693400 |

Technical data

Dimensions

| | |
|-----------------|-------|
| Length of cable | 0.5 m |
|-----------------|-------|

Ambient conditions

| | |
|---------------------------------|----------------------------------|
| Ambient temperature (operation) | -25 °C ... 85 °C (Plug / socket) |
| Degree of protection | IP67 |

General

| | |
|-----------------------|--|
| Note | The electrical and mechanical data specified assume that the connector pair is correctly locked and mounted. If the connector is unlocked and if there is a danger of contamination, the connector must be sealed using a protective cap > IP54. Influences arising from litz wires, cables or PCB assembly must also be taken into consideration. |
| Rated current at 40°C | 12 A |
| Rated voltage | 63 V |

Flush-type connector - SACC-E-M12FST-4CON-M16/0,5 - 1424138

Technical data

General

| | |
|-----------------------------|--|
| Rated surge voltage | 1.5 kV |
| Number of positions | 4 |
| Insulation resistance | ≥ 100 MΩ |
| Coding | T power |
| Standards/regulations | M12 connector IEC 61076-2-111 In line with |
| Signal type/category | Power |
| Status display | No |
| Overvoltage category | III |
| Degree of pollution | 3 |
| Test voltage | 1.5 kV |
| Connection method | Individual wires |
| Insertion/withdrawal cycles | > 100 |
| Torque | M12 connector |
| Mounting type | Front mounting M16 x 1.5 |

Material

| | |
|--|---------------------------|
| Flammability rating according to UL 94 | V0 |
| Contact material | CuZn |
| Contact surface material | Au |
| Contact carrier material | PA |
| Material, knurls | CuZn alloy, nickel-plated |
| Sealing material | FKM |
| Additional material specifications | PU 2K (Grout material) |

Cable

| | |
|------------------------------------|--|
| Cable type | UL/cUL stranded hook-up wire |
| Conductor cross section | 1.31 mm² |
| AWG signal line | 16 |
| Core diameter including insulation | 2 mm |
| Wire colors | Black, brown, blue, white |
| Conductor material | Bare Cu litz wires |
| Standards/specifications | M12 connector IEC 61076-2-111 In line with |
| Flame resistance | in acc. to UL 1581 VW1 |
| Halogen-free | yes |
| Ambient temperature (operation) | -40 °C ... 105 °C (cable, fixed installation) |
| | -20 °C ... 105 °C (cable, flexible installation) |

Standards and Regulations

| | |
|-----------------------|------------------------|
| Standard designation | M12 connector |
| Standards/regulations | IEC 61076-2-111 |
| Flame resistance | in acc. to UL 1581 VW1 |
| Halogen-free | yes |

Flush-type connector - SACC-E-M12FST-4CON-M16/0,5 - 1424138

Technical data

Standards and Regulations

| | |
|--|----|
| Flammability rating according to UL 94 | V0 |
|--|----|

Environmental Product Compliance

| | |
|------------|---|
| REACH SVHC | Lead 7439-92-1 |
| China RoHS | Environmentally Friendly Use Period = 50 |
| | For details about hazardous substances go to tab "Downloads", Category "Manufacturer's declaration" |

Drawings

Schematic diagram

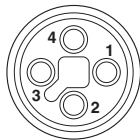

Pin assignment of M12 socket, 4-pos., T-coded, socket side view

Dimensional drawing

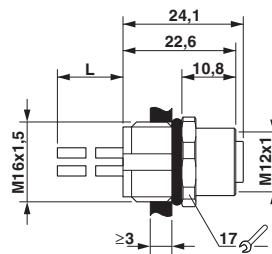

M12 flush-type socket

Circuit diagram

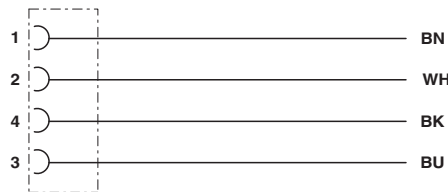

Contact assignment of the M12 socket

Approvals

Approvals

Approvals

UL Listed / cUL Listed / EAC / cULus Listed

Ex Approvals

Flush-type connector - SACC-E-M12FST-4CON-M16/0,5 - 1424138

Approvals

Approval details

| | | | |
|----------------------------|--|---|---------------|
| UL Listed | | http://database.ul.com/cgi-bin/XYV/template/LISEXT/1FRAME/index.htm | FILE E 468743 |
| | | | |
| Nominal voltage UN | | 63 V | |
| Nominal current IN | | 12 A | |
| mm ² /AWG/kcmil | | 16 | |

| | | | |
|----------------------------|--|---|---------------|
| cUL Listed | | http://database.ul.com/cgi-bin/XYV/template/LISEXT/1FRAME/index.htm | FILE E 468743 |
| | | | |
| Nominal voltage UN | | 63 V | |
| Nominal current IN | | 12 A | |
| mm ² /AWG/kcmil | | 16 | |

| | | |
|-----|--|---------|
| EAC | | B.01742 |
|-----|--|---------|

| | |
|--------------|--|
| cULus Listed | |
|--------------|--|

Phoenix Contact 2018 © - all rights reserved
<http://www.phoenixcontact.com>

PHOENIX CONTACT GmbH & Co. KG
Flachsmarktstr. 8
32825 Blomberg
Germany
Tel. +49 5235 300
Fax +49 5235 3 41200
<http://www.phoenixcontact.com>