

**Bench Adapter
Assembly
For Air-Powered
Crimp Tool**

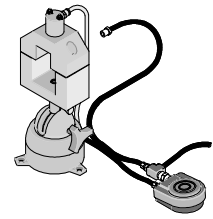

**Application Tooling
Specification Sheet**



Order No. 19078-0307

Features

- Higher volume output with less operator fatigue
- Operates on standard shop air (85-95 PSI)
- Perfect for assembly line operations.

SCOPE

This bench adapter assembly 19078-0307 with foot switch is intended for use with the 19279-0001 (AT-200 Air-Powered Crimping Tool) and/ or with Electrical Control Box (Order No. 64001-4000).

OPERATION

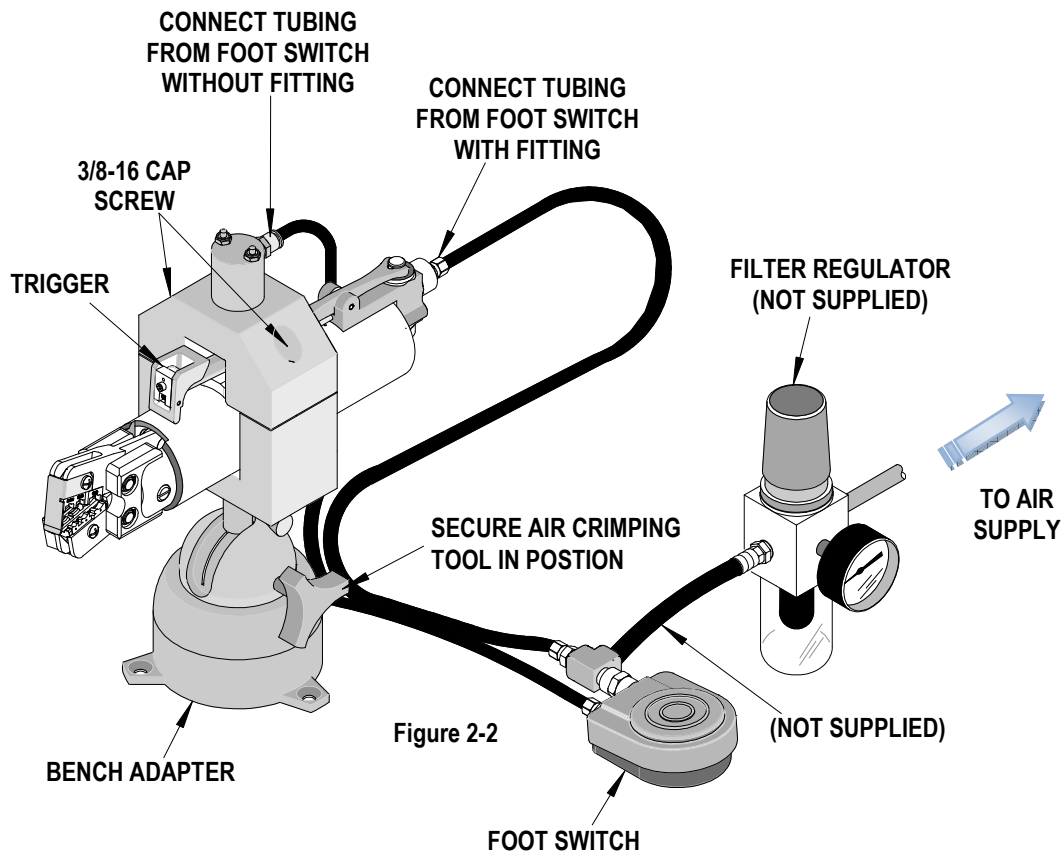

Mounting the Bench Adapter

When using the bench adapter assembly, be sure the base is securely fastened to a clean, sturdy workbench or table in a well-lighted area.

Fasten the stand with (3) #1/4-20 FHCS, nuts, and washers, not supplied, of sufficient length for the work bench.

Connecting the Crimping Tool

1. After mounting the bench adapter assembly, remove the air hose (Order No. 19279-0140) from the crimp tool and connect the tubing from the footswitch. See Figure 1.
2. When using the optional electrical controls with the bench adapter, (Order No. 64001-4000), refer to the operation manual Document No. TM-192790001.
3. Loosen the (2) two 3/8-16 cap screws enough to allow the crimp tool to pass through the opening in the bench adapter. See Figure 1.
4. Slide the crimp tool head through the opening of the bench adapter until the crimp tool is approximately 1/3 to 1/2 through the bench adapter. See Figure 1.
5. Rotate the crimp tool until the trigger is beneath the air cylinder end. See Figure 1.
6. Hold the crimp tool in position and tighten the (2) two 3/8-16 cap screws evenly to secure the crimp tool. There will be a small gap between the upper and lower halves of the bench adapter after tightening the cap screws.

Parts List

19078-0307-Optional Bench Adapter Figure 2				
Item	Order No.	Engineering No.	Description	Qty
1	N/A	N/A	Dual Air Hose (1/8 ID by 8')	1**
2	N/A	N/A	Air Foot Switch (3B – 30A2 – S)	1**
3	N/A	N/A	1/8" NPT – M Fitting, by 1/8 Barb	3**
4	N/A	N/A	1/8" Close Nipple (M/M)	1**
5	N/A	N/A	Clippard Thread on Hose Clamp	2**
6	N/A	N/A	1/8" Fitting Brass Pipe Tee M/F/F	1**
7	N/A	N/A	1/8" Brass Coupling - 1/8 (F/F)	1**

** Available from an industrial supply company such as MSC (1-800-645-7270).

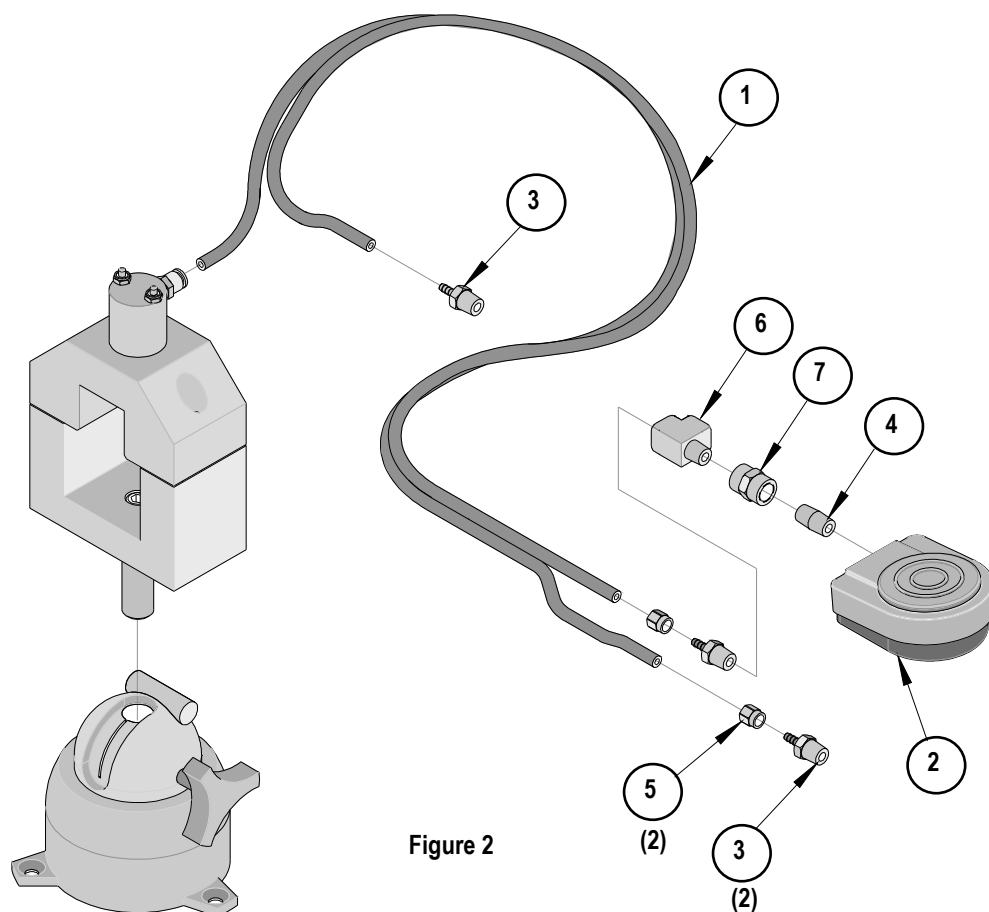

Figure 2

Visit our Web site at <http://www.molex.com>