

# Flush-type connector - SACC-E-MINMS-3CON-PG13/0.5 - 1521410

Please be informed that the data shown in this PDF Document is generated from our Online Catalog. Please find the complete data in the user's documentation. Our General Terms of Use for Downloads are valid (<http://download.phoenixcontact.com>)



Sensor/actuator flush-type connector, 3-pos., 7/8", front mounting with Pg13.5 thread, with 0.5 m PVC litz wire, 3 x 0.75 mm<sup>2</sup>



## Key commercial data

|                        |   |
|------------------------|---|
| Packing unit           | 1   |
| Minimum order quantity | 1   |
| Catalog page           | Page 37 (PC-2011)   |
| GTIN                   | <br>4 017918 949631 |
| Custom tariff number   | 85366990  |
| Country of origin      | GERMANY   |

## Technical data

### General data

|                                 |                              |
|---------------------------------|------------------------------|
| Rated current at 40°C           | 12 A                         |
| Rated voltage                   | 250 V                        |
| Number of positions             | 3                            |
| Volume resistance               | ≤ 5 mΩ                       |
| Insulation resistance           | ≥ 100 MΩ                     |
| Length of cable                 | 0.5 m                        |
| Ambient temperature (operation) | -40 °C ... 85 °C (connector) |

### General characteristics

|                          |                              |
|--------------------------|------------------------------|
| Coding                   | A - standard                 |
| Surge voltage category   | II                           |
| Pollution degree         | 3                            |
| Degree of protection     | IP67                         |
| Contact material         | CuZn                         |
| Contact surface material | Au                           |
| Contact carrier material | PUR                          |
| Material, knurls         | Zinc die-cast, nickel-plated |
| Sealing material         | Viton                        |

# Flush-type connector - SACC-E-MINMS-3CON-PG13/0.5 - 1521410

## Technical data

### General characteristics

|                   |                       |
|-------------------|-----------------------|
| Mounting type     | Front mounting Pg13.5 |
| Connection method | Individual wires      |
| Status display    | No                    |

### Conductor data

|                                    |                           |
|------------------------------------|---------------------------|
| Cable type                         | PVC litz wire             |
| Conductor cross section            | 0.75 mm <sup>2</sup>      |
| AWG signal line                    | 18                        |
| Conductor structure signal line    | 24x 0.20 mm               |
| Core diameter including insulation | 2.7 mm                    |
| Thickness, insulation              | 0.85 mm (Core insulation) |
| Wire colors                        | green/yellow, brown, blue |
| Material conductor insulation      | PE                        |

## Classifications

### eclass

|            |          |
|------------|----------|
| eCl@ss 4.0 | 27140815 |
| eCl@ss 4.1 | 27140815 |
| eCl@ss 5.0 | 27143423 |
| eCl@ss 5.1 | 27143423 |
| eCl@ss 6.0 | 27143423 |
| eCl@ss 7.0 | 27449001 |

### etim

|          |          |
|----------|----------|
| ETIM 2.0 | EC001297 |
| ETIM 3.0 | EC002061 |
| ETIM 4.0 | EC002061 |

### unspsc

|               |          |
|---------------|----------|
| UNSPSC 6.01   | 31251501 |
| UNSPSC 7.0901 | 31251501 |
| UNSPSC 11     | 31251501 |
| UNSPSC 12.01  | 31251501 |
| UNSPSC 13.2   | 31251501 |

## Approvals

### Approvals

#### Approvals

UL Recognized / cUL Recognized / GOST / cULus Recognized

# Flush-type connector - SACC-E-MINMS-3CON-PG13/0.5 - 1521410

## Approvals

Ex Approvals

Approvals submitted

### Approval details

|                                |       |
|--------------------------------|-------|
| UL Recognized                  |       |
| mm <sup>2</sup> /AWG/kcmil     | 20    |
| Nominal current I <sub>N</sub> | 10 A  |
| Nominal voltage U <sub>N</sub> | 600 V |

|                                |       |
|--------------------------------|-------|
| cUL Recognized                 |       |
| mm <sup>2</sup> /AWG/kcmil     | 20    |
| Nominal current I <sub>N</sub> | 10 A  |
| Nominal voltage U <sub>N</sub> | 600 V |

|      |  |
|------|--|
| GOST |  |
|------|--|

|                  |  |
|------------------|--|
| cULus Recognized |  |
|------------------|--|

## Drawings

Dimensioned drawing

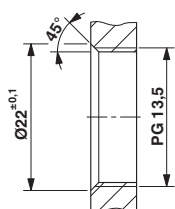

Mounting panel with thread

Dimensioned drawing

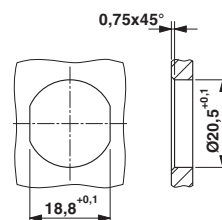

Mounting panel with feed-through hole

# Flush-type connector - SACC-E-MINMS-3CON-PG13/0.5 - 1521410

Schematic diagram

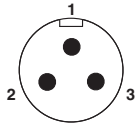

Pin assignment, plug, 7/8"-16UNF, 3-pos., view of male side

# Flush-type connector - SACC-E-MINMS-3CON-PG13/0.5 - 1521410

Dimensioned drawing

