

REV.	DATE	DESCRIPTION
A	12/14/00	MODIFY MOUNTING LEGS
B	01/05/03	MODIFY MOUNTING LEGS
C	08/25/04	ADD RECOMMENDED PCB LAYOUT

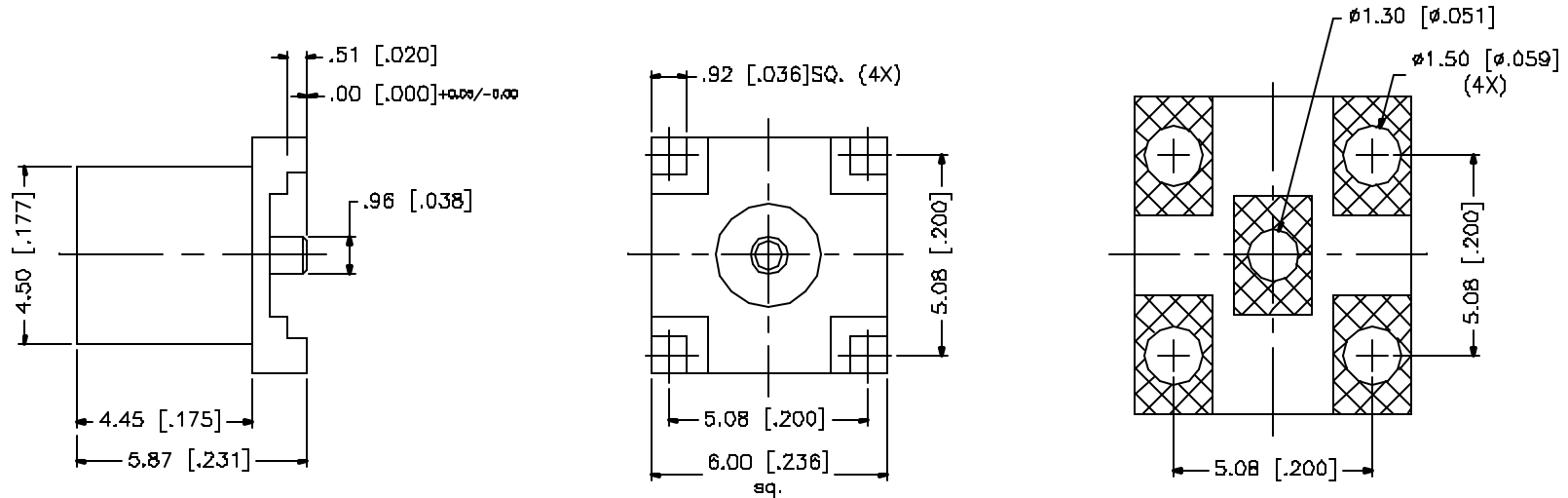

8				
7				
6				
5				
4				
3	INSULATOR	TEFLON	NATURAL	1
2	CONTACT PIN	BER. COPPER	GOLD	1
1	HOUSING/BODY	BRASS	GOLD	1
	DESCRIPTION	MATERIAL	FINISH	QTY

UNLESS OTHERWISE SPECIFIED DIMENSIONS ARE IN MILLIMETERS. DIMENSIONS IN [ ] ARE IN INCHES AND FOR CUSTOMER REFERENCE ONLY.

UNLESS OTHERWISE SPECIFIED TOLERANCES FOR MILLIMETERS ARE:  
 D - 8mm ± 0.20mm  
 B - 30mm ± 0.40mm  
 30 - 120mm ± 0.50mm

UNLESS OTHERWISE SPECIFIED TOLERANCES FOR INCHES ARE:  
 .020 - .315 = ± 0.007"  
 .315 - 1.180 = ± 0.015"  
 1.180 - 4.724 = ± 0.020"

DO NOT SCALE DRAWING

APPROVALS		DATE
DRAWN	G.R.S.	08/25/04
CHECKED		
ISSUED		
SHEET	1 OF 1	
CAD FILE	C:/252/252117.DWG	

# Amphenol Connex

PART DESCRIPTION  
**MCX P.C. BOARD RECEPT. JACK  
 (SURFACE MOUNT - 50ohms)**

PART NO. **252117**

DWG. NO.	252117.DWG	REV.	C	SIZE	A	SCALE	NA
----------	------------	------	---	------	---	-------	----