

Connector assembly frame - HC-SMP 125-B10-AMQ - 1660960

Please be informed that the data shown in this PDF Document is generated from our Online Catalog. Please find the complete data in the user's documentation. Our General Terms of Use for Downloads are valid (<http://download.phoenixcontact.com>)



HEAVYCON connector assembly frame with panel mounting base with double locking latch, for contact inserts of type B10



Key commercial data

Packing unit	1 1
GTIN	 4 017918 022372
Weight per Piece (excluding packing)	205.58 GRM
Custom tariff number	85389099
Country of origin	Germany

Technical data

Dimensions

Length	125 mm
Height	52 mm
Hole diameter	4.5 mm
Drill hole distance, horizontal	104 mm
Drill hole distance, vertical	32 mm

General

Note	For contact inserts B10, BB18, DD42 and HV3
Material	PA
Inflammability class according to UL 94	HB
Design	B10

Connector assembly frame - HC-SMP 125-B10-AMQ - 1660960

Classifications

eCl@ss

eCl@ss 4.0	27140816
eCl@ss 4.1	27140816
eCl@ss 5.0	27143424
eCl@ss 5.1	27143424
eCl@ss 6.0	27143424
eCl@ss 7.0	27440209
eCl@ss 8.0	27440209

ETIM

ETIM 3.0	EC002310
ETIM 4.0	EC002310
ETIM 5.0	EC002310

UNSPSC

UNSPSC 6.01	43172601
UNSPSC 7.0901	39121416
UNSPSC 11	43172601
UNSPSC 12.01	39121408
UNSPSC 13.2	39121408

Approvals

Approvals

Approvals

GOST

Ex Approvals

Approvals submitted

Approval details

GOST 
--

Connector assembly frame - HC-SMP 125-B10-AMQ - 1660960

Drawings

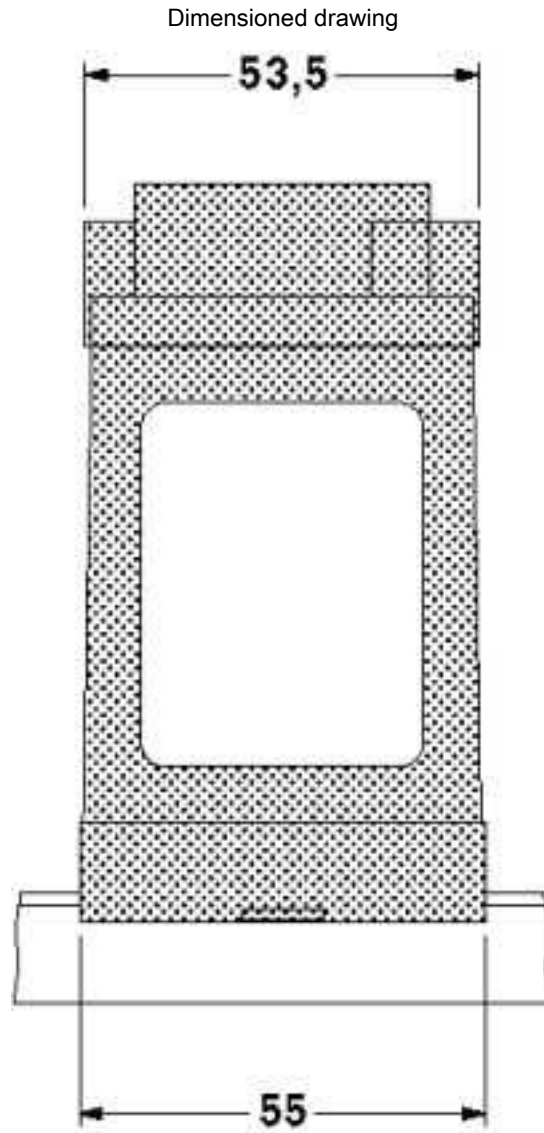

Connector assembly frame - HC-SMP 125-B10-AMQ - 1660960

Dimensioned drawing

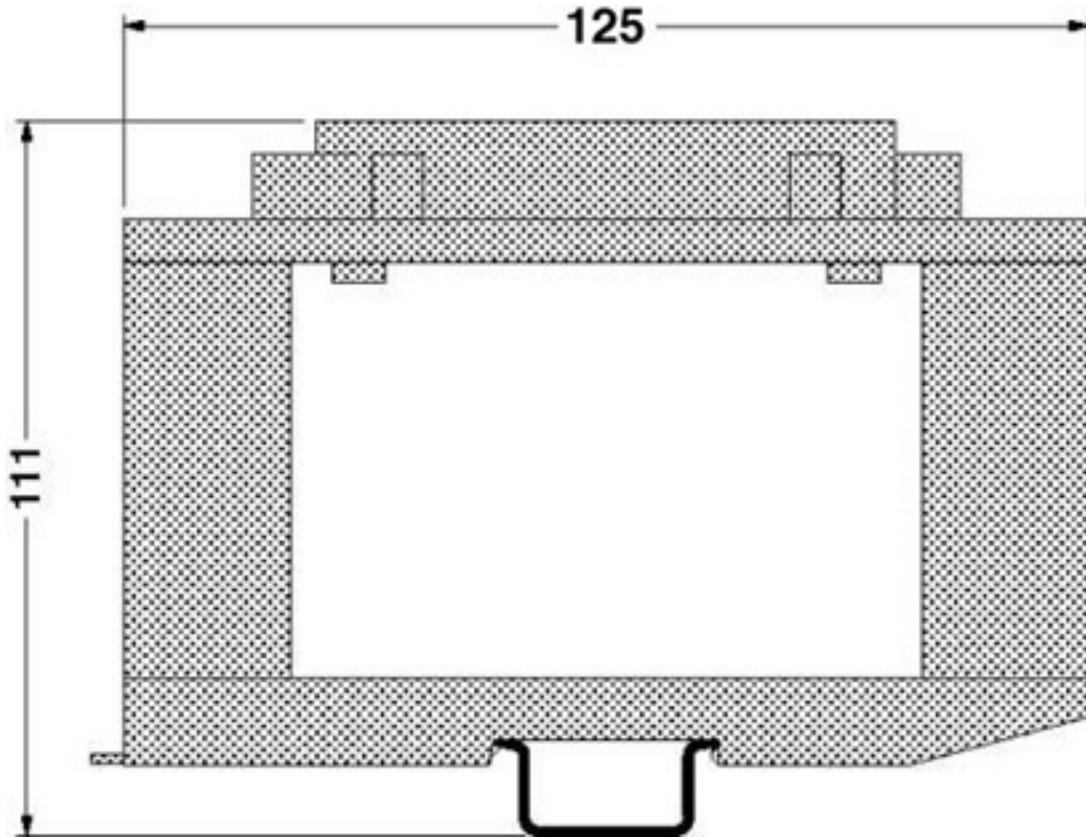

Connector assembly frame - HC-SMP 125-B10-AMQ - 1660960

