

4

3

2

1

THIS DRAWING IS UNPUBLISHED.

RELEASED FOR PUBLICATION

© COPYRIGHT

ALL RIGHTS RESERVED.

LOC DIST

REVISIONS

P	LTR	DESCRIPTION	DATE	DWN	APVD

REPLACED BY OCEAN STYLE APPLICATOR PART NUMBER

FOR REPLACEMENT PARTS FOR APPLICATOR REFER TO ADDITIONAL PAGE(S). SPARE PARTS KIT (IF LISTED) WILL REMAIN AVAILABLE.

THE REPLACEMENT OCEAN STYLE APPLICATOR HAS THE SAME TERMINATOR/PRESS INTERFACE AS APPLICATOR

THIS DRAWING IS A CONTROLLED DOCUMENT.		DWN	 TE Connectivity		
DIMENSIONS:		CHK			
TOLERANCES UNLESS OTHERWISE SPECIFIED:		APVD	NAME		
 <ul style="list-style-type: none"> 0 PLC ± 1 PLC ± 2 PLC ± 3 PLC ± 4 PLC ± ANGLES ± 		PRODUCT SPEC	RESTRICTED TO		
		APPLICATION SPEC	SIZE	CAGE CODE	DRAWING NO
MATERIAL	FINISH	WEIGHT	A3	C-	
		SCALE	SHEET	OF	REV

PART NUMBER	REV	FIRST USED
567373-1	J	854400-1
567373-2	J	565435-5
567373-3	J	354500-1
7-567373-7	G	-

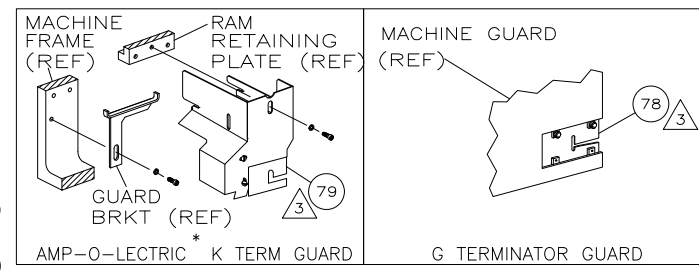

TERMINAL NAME: RECEPTACLE CST .100

(A) 770601	
(B) 1375819	
647607	

CRIMPING DATA

PAD LTR	CRIMP HEIGHT	WIRE SIZE
A	.034 ±.002	22
B	.032 ±.002	24
C	.030 ±.002	26
D	NOT USED	

CRIMP	SIZE	TYPE	RANGE
WIRE	.042	F	26-22
INSUL	.070	F	.035-.065
FEED	.360	408-8040	458637-1 L1380
WIRE STRIP LENGTH	.100-.125		

LOC A DIST 66

REV	DESCRIPTION	DATE	BY	APPV
J1	ECR-07-020462	8-2007	MY	GB

-1	LEADMAKER	MECH POST FEED	-77	SPARE TOOLING KIT
-2	BENCH MODEL K	MECH PRE FEED		
-3	BENCH MODEL G	MECH PRE FEED		

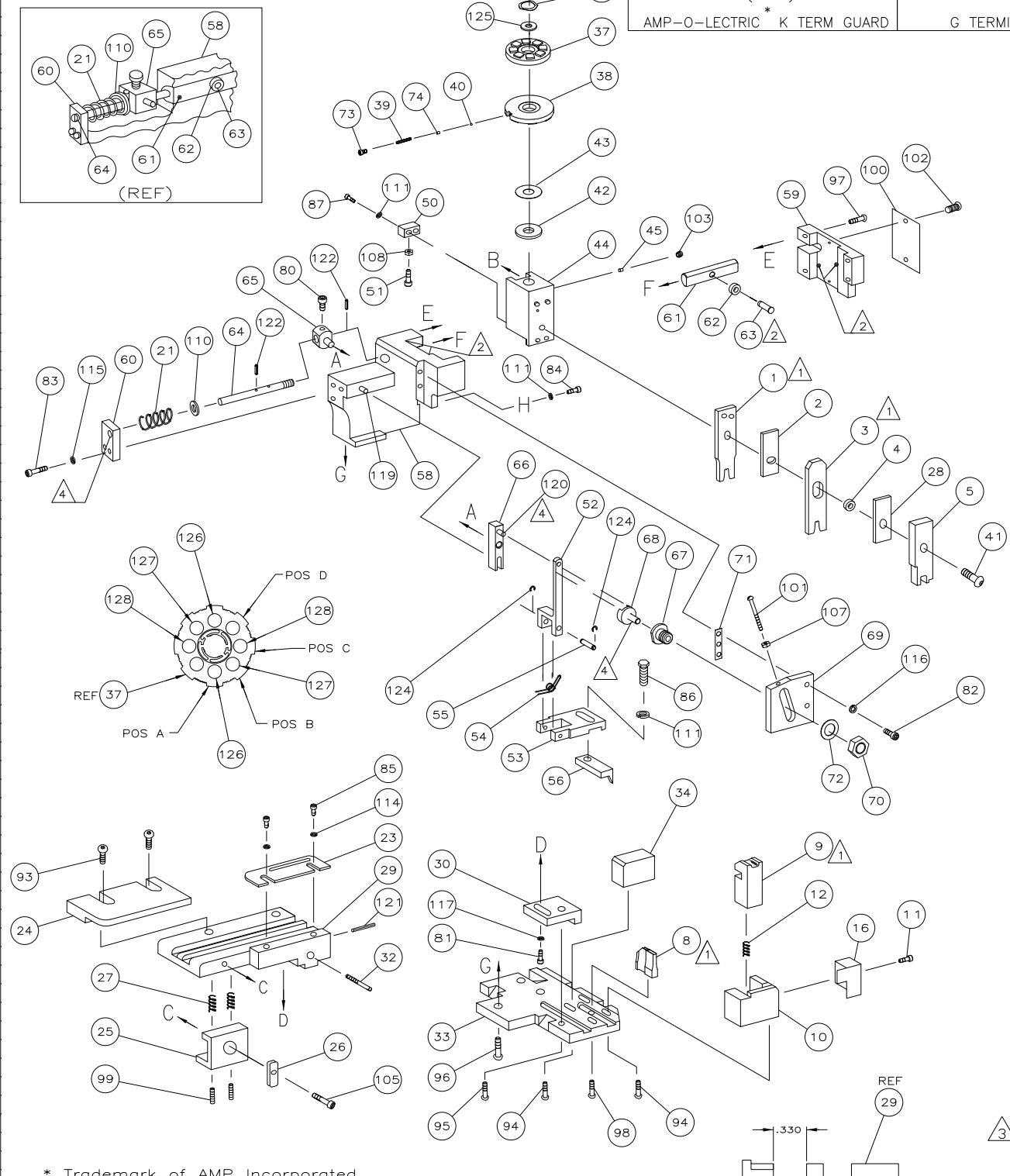

QTY	REQD	PER	ASSY	PART NO	DESCRIPTION	ITEM NO	
-	2	2	2	-	5-354779-2	PIN, WIRE DISC (.3250)C	129
-	2	2	2	-	4-354779-9	PIN, WIRE DISC (.3235)B	127
-	2	2	2	-	4-354779-7	PIN, WIRE DISC (.3225)A	126
-	1	1	1	-	986950-1	WASHER, FLAT PRECISION	125
-	REF	REF	REF	-	21045-3	RING, RET "C" (Ø.187)FD FING PIN	124
-	REF	REF	REF	-			123
-	REF	REF	REF	-	5-21028-1	PIN, SLT SPR (Ø.125x.50)ADJ ROD	122
-	1	1	1	-	4-21028-0	PIN, SLT SPR (Ø.093x.75)ST GDE PL	121
-	REF	REF	REF	-	1-21030-1	PIN, DOWEL (Ø.187x.50)LEVER	120
-	REF	REF	REF	-	1-21030-6	PIN, DOWEL (Ø.187x1.25)HOUSING	119
-							118
-	1	1	1	-	21024-5	WASHER, LOCK (#10)ADJ BLOCK	117
-	REF	REF	REF	-	21024-5	WASHER, LOCK (#10)ADJ PLATE	116
-	REF	REF	REF	-	21024-5	WASHER, LOCK (#10)FEED GDE ROD	115
-	2	2	2	-	21024-2	WASHER, LOCK (#4)FRONT STP GUIDE	114
-							113
-	4	4	4	-	21024-4	WASHER, LOCK (#8)STRIPPER	111
-	REF	REF	REF	-	21899-4	WASHER, FLAT (Ø5/16)SCREW ADJ	110
-							109
-	1	1	1	-	21018-5	NUT, HEX (NO.6)HOLDDOWN	108
-	REF	REF	REF	-	21018-5	NUT, HEX (6-32)FEED ADJ	107
-							106
-	1	1	1	-	22353-8	SCR, SHLD (Ø.187x.25)DRAG LEVER	105
-							104
-	1	1	1	-	21009-2	SCR, SKT SET (1/4-20x.25 LW)RAM	103
-	2	2	2	-	21017-2	SCR, DRIVE (#2x.19)ID PLATE	102
-	REF	REF	REF	-	6-23715-5	SCR, PAN HD (6-32x1.50)FEED ADJ	101
-	1	1	1	-	461264-1	PLATE, IDENTIFICATION	100
-	2	2	2	-	5-21006-6	SCR, SET (10-32x.75)DRAG	99
-	1	1	1	-	22733-8	SCR, BHC (8-32x.38 LW)ANVIL	98
-	REF	REF	REF	-	2-21002-9	SCR, BHC (10-32x.75)CAP	97
-	REF	REF	REF	-	2-22733-8	SCR, BHC (1/4-20x.62)HOUSING	96
-	REF	REF	REF	-	2-21002-7	SCR, BHC (10-32x.50)SG ADJ BLOCK	95
-	4	4	4	-	2-21002-2	SCR, BHC (8-32x.50)SHEAR	94
-	2	2	2	-	2-21002-1	SCR, BHC (8-32x.38)R STRIP GUIDE	93
-							92
-	1	1	1	-	1-21002-7	SCR, BHC (6-32x.38)CAM	91
-							90
-							89
-							88
-	2	2	2	-	2-21000-7	SCR, SHC (8-32x.50)DEP-HOLD	87
-	1	1	1	-	2-22603-0	SCR, HEX HD (8-32x.31)FEED FINGER	86
-	2	2	2	-	1-21000-3	SCR, SHC (4-40x.25)F ST GUIDE	85
-	1	1	1	-	2-21000-7	SCR, SHC (8-32x.50)STRIPPER	84
-	REF	REF	REF	-	3-21000-7	SCR, SHC (10-32x.75)FEED ROD GD	83
-	REF	REF	REF	-	3-21000-6	SCR, SHC (10-32x.62)FD ADJ BLK	82
-	1	1	1	-	3-21000-4	SCR, SHC (10-32x.38)SG ADJ BL	81
-	REF	REF	REF	-	3-21000-4	SCR, SHC (10-32x.38)PIVOT BLK	80
-					455749-1	GUARD, WINDOW	79
-	REF				679532-1	INSERT, GUARD	78
-							77
-							76
-							75
-	1	1	1	-	690603-1	SPRING, ASSIST	74
-	1	1	1	-	23030-1	SCR, SHC (6-32x.25 SL)INS DISC	73
-	REF	REF	REF	-	458109-1	WASHER, SPECIAL	72
-	REF	REF	REF	-	690517-1	SPACER	71
-							70
-							69
-							68
-							67
-							66
-							65
-							64
-							63
-							62
-							61
-							60
-							59
-							58
-							57
-	1	1	1	-	458537-2	PAWL, FEED	56
-	REF	REF	REF	-	240624-1	PIN, FEED FINGER	55
-	REF	REF	REF	-	691499-1	SPRING, FEED FINGER	54
-	REF	REF	REF	-	690541-1	HOLDER, FEED FINGER	53
-	REF	REF	REF	-	455679-1	LEVER, TERMINAL FEED ARM	52
-	1	1	1	-	811242-2	BUMPER, HOLDDOWN	51
-	1	1	1	-	690753-1	SPACER, TONKER	50
-	1			-	690602-6	CAM, PRE-FEED 1 5/8 ST	49
-				-	690602-5	CAM, PRE-FEED 1 1/8 ST	48
-				-	690501-4	CAM, POST-FEED 1 5/8 ST	47
-	1	1	1	-	459456-1	APPLICATOR, BASIC (SUBASSY)	46
-	1	1	1	-	690191-1	PLUG, NYLON	45
-	1	1	1	-	455673-1	RAM	44
-	1	1	1	-	690125-1	WASHER, LAMINATED	43
-	1	1	1	-	690124-1	WASHER, RAM	42
-	1	1	1	-	7-21002-9	BOLT, CRIMPER (5/16x1.00)	41
-	1	1	1	-	23241-6	BALL, STEEL	40
-	1	1	1	-	690170-1	SPRING, COMPRESSION	39
-	1	1	1	-	690142-1	DISC, INSULATION	38
-	1	1	1	-	354777-1	WIRE DISC, PLASTIC	37
-	1	1	1	-	22480-5	WASHER, SPRING	36
-	1	1	1	-	690212-1	POST, RAM	35
-	1	1	1	-	690786-3	SUPPORT, TERMINAL	34
-	REF	REF	REF	-	455675-1	PLATE, BASE	33
-	1	1	1	-	690432-3	SCREW, ADJUSTMENT	32
-							31
-	REF	REF	REF	-	455689-1	BLOCK, STRIP GUIDE ADJ	30
-	1	1	1	-	843869-1	PLATE, STRIP GUIDE	29
-	1	1	1	-	455888-3	SPACER, FRONT SHEAR DEP	28
-	2	2	2	-	1-22284-0	SPRING, DRAG	27
-	1	1	1	-	356835-1	LEVER, DRAG RELEASE	26
-	1	1	1	-	240792-1	DRAG, TERMINAL	25
-	1	1	1	-	9-690504-9	GUIDE, STRIP (REAR)	24
-	1	1	1	-	690438-1	GUIDE, STRIP (FRONT)	23
-					690472-2	STRIPPER	22
-	REF	REF	REF	-	4-22284-9	SPRING, FEED RETURN	21
-							20
-	1	1		-	691353-1	STRIPPER	19
-							18
-							17
-	1	1	1	-	318563-1	GUARD, CHIP (FRONT)	16
-							15
-							14
-							13
-	1	1	1	-	3-22280-3	SPRING, SHEAR	12
-	1	1	1	-	690461-1	STOP, SHEAR	11
-	1	1	1	-	690459-1	HOLDER, SHEAR (FRONT)	10
-	1	1	1	-	462006-1	SHEAR, FLOAT (FRONT)	9
-	1	1	1	-	9-803653-9	ANVIL	8
-							7
-							6
-	1	1	1	-	2-455889-9	DEPRESSOR, SHEAR (FRONT)	5
-	1	1	1	-	238011-7	SPACER, BLOCK CRIMPER	4
-	1	1	1	-	9-456134-3	CRIMPER, INSULATION	3
-	1	1	1	-	455888-8	SPACER, CRIMPER	2
-	1	1	1	-	2-456401-1	CRIMPER, WIRE	1

QTY	REQD	PER	ASSY	PART NO	DESCRIPTION	ITEM NO	
-	22594-8				NUT, HEX (1/2-20)	70	
-	240628-1				PLATE, ADJUSTMENT	69	
-	240626-1				SHAFT, PIVOT	68	
-	240633-1				BUSHING	67	
-	455680-1				LEVER, INTERMEDIATE	66	
-	240629-1				BLOCK, PIVOT	65	
-	240632-2				SCREW, ADJ FEED ROD	64	
-	240659-3				PIN, CAM ROLLER	63	
-	240658-1				ROLLER, CAM	62	
-	454398-2				ROD, FEED	61	
-	454178-1				GUIDE, FEED ROD	60	
-	454220-1				CAP, RAM	59	
-	454485-1				HOUSING	58	
-						57	
-	1	1	1	-	458537-2	PAWL, FEED	56
-	REF	REF	REF	-	240624-1	PIN, FEED FINGER	55
-	REF	REF	REF	-	691499-1	SPRING, FEED FINGER	54
-	REF	REF	REF	-	690541-1	HOLDER, FEED FINGER	53
-	REF	REF	REF	-	455679-1	LEVER, TERMINAL FEED ARM	52
-	1	1	1	-	811242-2	BUMPER, HOLDDOWN	51
-	1	1	1	-	690753-1	SPACER, TONKER	50
-	1			-	690602-6	CAM, PRE-FEED 1 5/8 ST	49
-				-	690602-5	CAM, PRE-FEED 1 1/8 ST	48
-				-	690501-4	CAM, POST-FEED 1 5/8 ST	47
-	1	1	1	-	459456-1	APPLICATOR, BASIC (SUBASSY)	46
-	1	1	1	-	690191-1	PLUG, NYLON	45
-	1	1	1	-	455673-1	RAM	44
-	1	1	1	-	690125-1	WASHER, LAMINATED	43
-	1	1	1	-	690124-1	WASHER, RAM	42
-	1	1	1	-	7-21002-9	BOLT, CRIMPER (5/16x1.00)	41
-	1	1	1	-	23241-6	BALL, STEEL	40
-	1	1	1	-	690170-1	SPRING, COMPRESSION	39
-	1	1	1	-	690142-1	DISC, INSULATION	38
-	1	1	1	-	354777-1	WIRE DISC, PLASTIC	37
-	1	1	1	-	22480-5	WASHER, SPRING	36
-	1	1	1	-	690212-1	POST, RAM	35
-	1	1	1	-	690786-3	SUPPORT, TERMINAL	34
-	REF	REF	REF	-	455675-1	PLATE, BASE	33
-	1	1	1	-	690432-3	SCREW, ADJUSTMENT	32
-							31
-	REF	REF	REF	-	455689-1	BLOCK, STRIP GUIDE ADJ	30
-	1	1	1	-	843869-1	PLATE, STRIP GUIDE	29
-	1	1	1	-	455888-3	SPACER, FRONT SHEAR DEP	28
-	2	2	2	-	1-22284-0	SPRING, DRAG	27
-	1	1	1	-	356835-1	LEVER, DRAG RELEASE	26
-	1	1	1	-	240792-1	DRAG, TERMINAL	25
-	1	1	1	-	9-690504-9	GUIDE, STRIP (REAR)	24
-	1	1	1	-	690438-1	GUIDE, STRIP (FRONT)	23
-					690472-2	STRIPPER	22
-	REF	REF	REF	-	4-22284-9	SPRING, FEED	