

SUMMARY

Wires

| | |
|---------|----|
| Low | 30 |
| High | 0 |
| Coax | 0 |
| Triax | 0 |
| Quad | 0 |
| Fiber | 0 |
| Fluidic | 0 |

| | |
|------------------|-----------------|
| Series | 3M |
| Termination type | Male crimp |
| IP rating | 68 |
| Cable Ø | 7.50 - 15.00 mm |
| Matching parts | PMN.3M.330.XLM |
| Status | |
| Alternative part | |



Image is for illustrative purpose only

Download

[Request a quote](#)

[Catalog](#)

TECHNICAL DETAILS

Mechanics

| | |
|-------------------|---|
| Shell Style/Model | FM*: Straight plug, key (N) or keys (P, R, S, T, U, V, W and X) with knurled grip |
| Keying | |
| Housing Material | Environment friendly aluminium (nickel plated, anthracite color) shell and nut, other pieces bronze/brass |
| Cable Fixing | ∅ 7.5 - 15 mm |
| Variant | |

Performance

| | |
|---------------|-------------------------|
| Configuration | 3M.330 : 30 Low Voltage |
| Insulator | |
| Rated Current | 3.5 Amps |

Specifications

| |
|--------------------------------|
| Contact Type: Crimp |
| Max. Matings: 5000 |
| Contact Retention: 22 N |
| Contact Dia.: 0.7 mm (0.028in) |
| Bucket Dia.: 0.8 mm (0.031in) |

Min. Conductor: 0.14 mm² (AWG 26)
 Max. Conductor: 0.34 mm² (AWG 22)
 R (max): 6.1 mOhm
 Test voltage (kV rms) Contact-contact: 1.10
 Test voltage (kV rms) Contact-shell: 1.00

Others

Humidity (max): <=95% [at 60 deg C / 140 F]
 Vibration: 15 g [10 Hz - 2000 Hz]
 Shock Resistance: 100 g [6 ms]
 Operating temperature: -55° C/ +200° C
 Climatical Category: 15/200/21 (Al. shell)
 Lighting strike EIA 364-75 10K amps - 6 times
 EMI Shielding EIA 364-66A - 1Ghz-80 dB,3GHz-70 dB,6GHz- 58dB
 IP Rating: 68

DRAWINGS

Draws

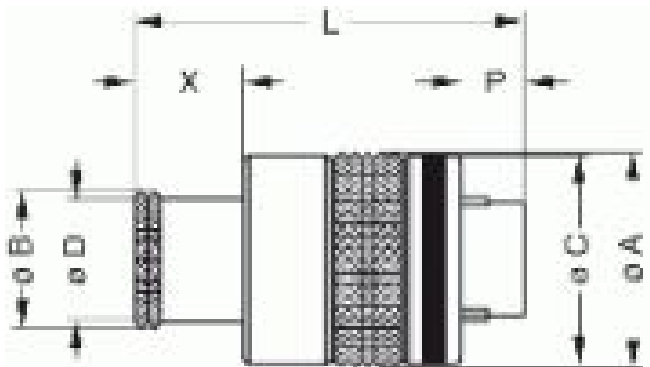

Dimensions

| | A | B | C | D | Lr | Ls | P | X |
|-----|------|------|------|------|------|------|------|------|
| mm. | 19.6 | 16 | 19.2 | 15 | 24.5 | 24.5 | 3.9 | 7.1 |
| in. | 0,77 | 0,63 | 0,76 | 0,59 | 0,96 | 0,96 | 0,15 | 0,28 |





RECOMMENDED BY LEMO

Tools

Crimp Tool: DPC.91.701.V
 Crimp settings: AWG/Selector = 22-24-26/6-5-5

Positionner: DCE.91.070.5MVC
 Extractor: DCF.93.070.4LT
 Replacement contact: FGN.0M.555.ZZC

Cables

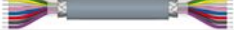
| | | | |
|--------------------|-----|-------|---|
| CMN.30.T22.087PGCE | PVC | GREY |  |
| CMN.30.T22.087PGZE | | Grey |  |
| CMN.30.T22.087PNCE | PVC | Black |  |
| CMN.30.T22.087PNZE | | |  |
| 330 240 | PVC | Black |  |
| 330 260 | PVC | Black |  |
| 430 250 | PVC | Grey |  |