

- NOTES:
1. MATERIAL: PHOSPHOR BRONZE ALLOY
  2. PLATING: 2.50µm/100µm TIN OVERALL  
OVER 1.25µm/50µm OVERALL NICKEL UNDERPLATING.
  3. PART CONFORMS TO PRODUCT SPECIFICATION PS-45579-001.
  4. TERMINAL FOR USE IN SPOX PLUG 45626.
  5. FOR TERMINAL ORIENTATION SEE DRAWING SD-45626-001.
  6. USE MOLEX EXTRACTION TOOL 63813-1400 TO REMOVE TERMINAL WITHOUT DAMAGE TO THE PLUG CORE. REMOVED TERMINAL IS NOT USABLE.
  7. CONTACT WIPE IN 45626-0001 HOUSING WHEN MATED TO 08-70-1045 TERMINAL IN 45579-0001 HOUSING:  
STANDARD WIPE (ALL CIRCUITS EXCEPT CKT 1) 2.28mm +0.23/-0.25  
FIRST-MAKE / LAST BREAK (CIRCUIT 1) 3.28mm +0.24/-0.26  
TOLERANCE CALCULATED BY ROOT MEAN SQUARE METHOD (RMS)

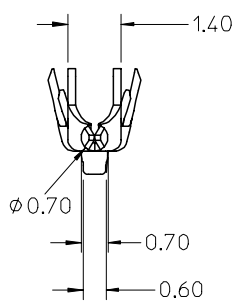

EC NO: UCP2005-2128 DRWN: MCARRANZ 2005/04/05 CHKD: JCOMERCI 2005/04/05 APPR: JCOMERCI 2005/04/08	QUALITY SYMBOLS	GENERAL TOLERANCES (UNLESS SPECIFIED)		SCALE 4:1	DESIGN UNITS METRIC	THIRD ANGLE PROJECTION	REVISE ON CAD ONLY	
	▽ = 0 ▽ = 0	mm	INCH	DIMENSION STYLE MM ONLY		TITLE 0.70MM SPOX MALE CRIMP PIN TERMINAL 22-24AWG		
		4 PLACES ± --- ± ---	3 PLACES ± --- ± ---	2 PLACES ± 0.13 ± ---	1 PLACE ± 0.25 ± ---	DRAWN BY KSTILES	DATE 2/26/2004	MOLEX INCORPORATED MATERIAL NO. 45627-0002 DOCUMENT NO. SD-45627-002 SHEET NO. 1 OF 1
		ANGULAR ± 1/2°				CHECKED BY MCARRANZ	DATE 05/17/04	
DESCRIPTION	DRAFT WHERE APPLICABLE		MUST REMAIN WITHIN DIMENSIONS		APPROVED BY JCOMERCI	DATE 05/18/04	THIS DRAWING CONTAINS INFORMATION THAT IS PROPRIETARY TO MOLEX INCORPORATED AND SHOULD NOT BE USED WITHOUT WRITTEN PERMISSION	
REV A1								