

LOC		DIST		REVISIONS			
AD	47	REV	DATE	BY	CHK	APPV	
M		REVISED PER ECO-05-010068	21DEC05	JDP	RW		
M1		REVISED PER ECO-09-021826	08JAN10	KK	AEG		

- 1 HOUSING MATERIAL: LIQUID CRYSTAL POLYMER PER ASTM D5138 LCP000 G30A 32250.
- 2 CONTACT MATERIAL: PHOSPHOR BRONZE PER UNS ALLOY NO. C51100, TEMPER: H04.
- 3 CONTACT FINISH:
 UNDERPLATE (ENTIRE CONTACT):
 0.00127 MIN NICKEL PER SAE-AMS-QQ-N-290
 ON MATING SURFACES:
 FLASH GOLD PER ASTM B 488, OVER
 0.00076 MIN PALLADIUM-NICKEL OVER UNDERPLATE, OR
 0.00076 MIN GOLD PER ASTM B 488 OVER UNDERPLATE.
 ON LEADS:
 0.00127 MIN TIN-LEAD OVER UNDERPLATE.
 LUBRICATION (MIN MATING SURFACES):
 SURFACE CONDITIONER AFTER PLATING.
- 4 PART MARKING PER AMP SPEC 115-9009.
 LOCATED APPROXIMATELY AS SHOWN.
- 5 OBSOLETE PARTS: OBSOLETE CIS STREAMLINING PER D.RENAUD/D.SINISI

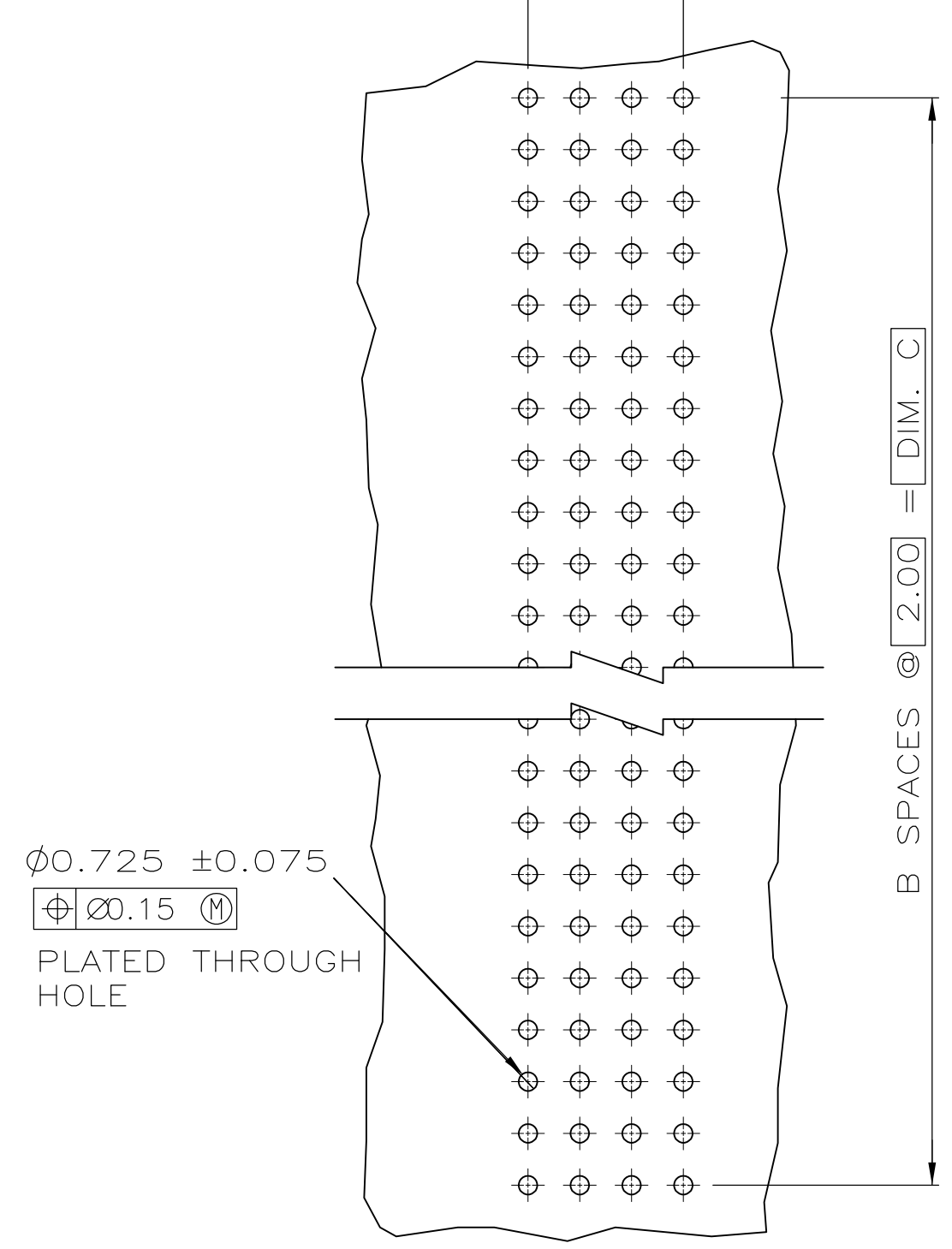
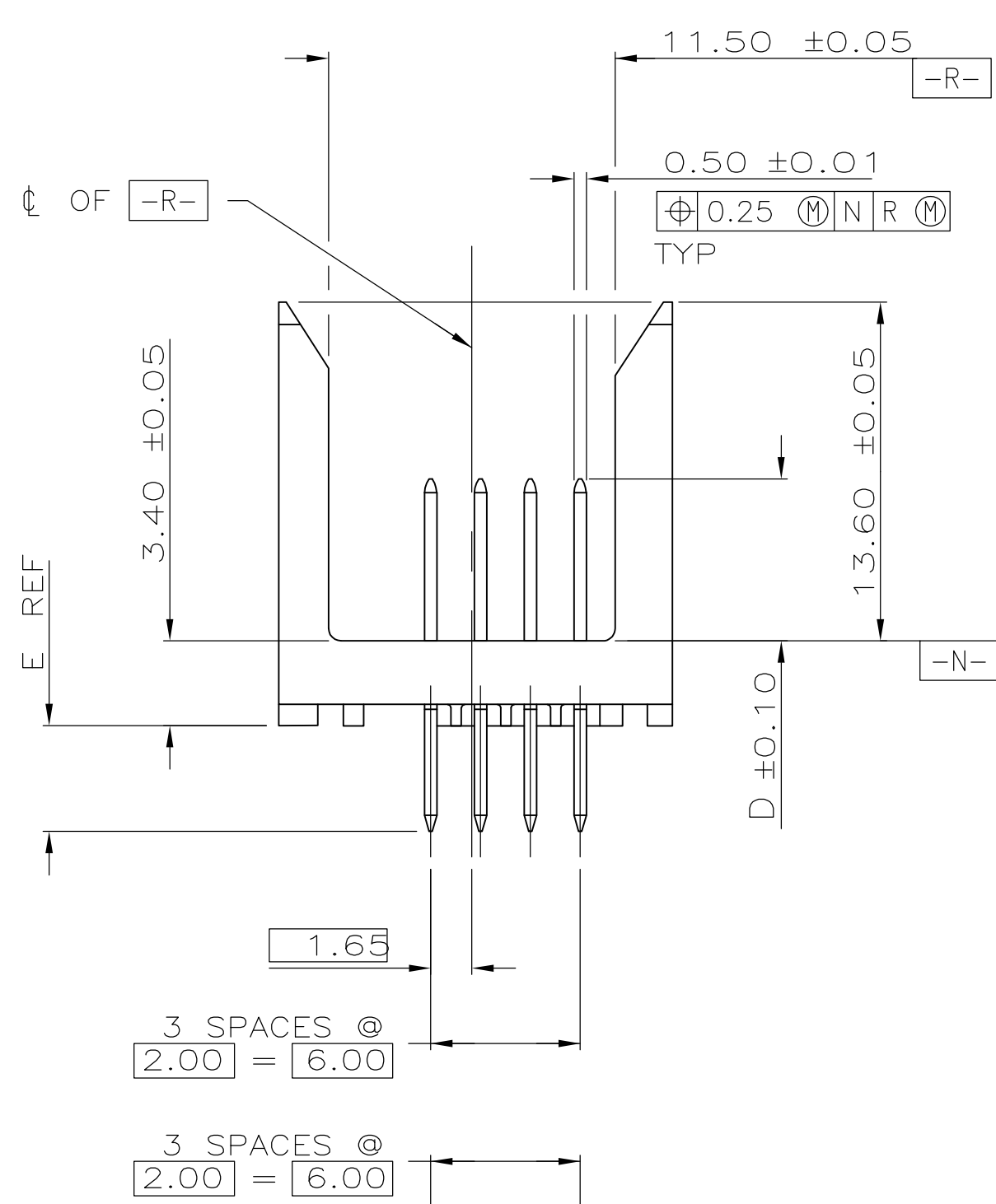
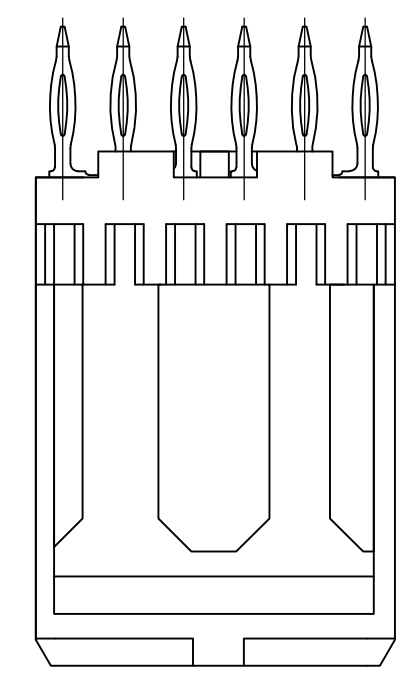
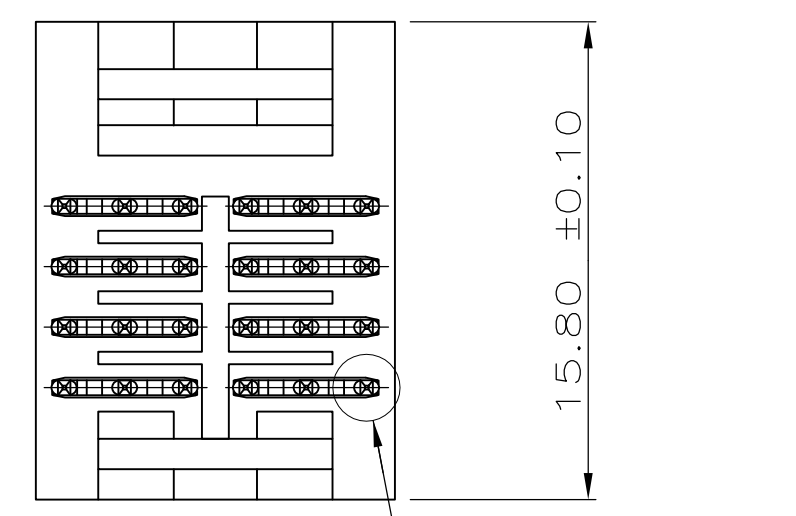
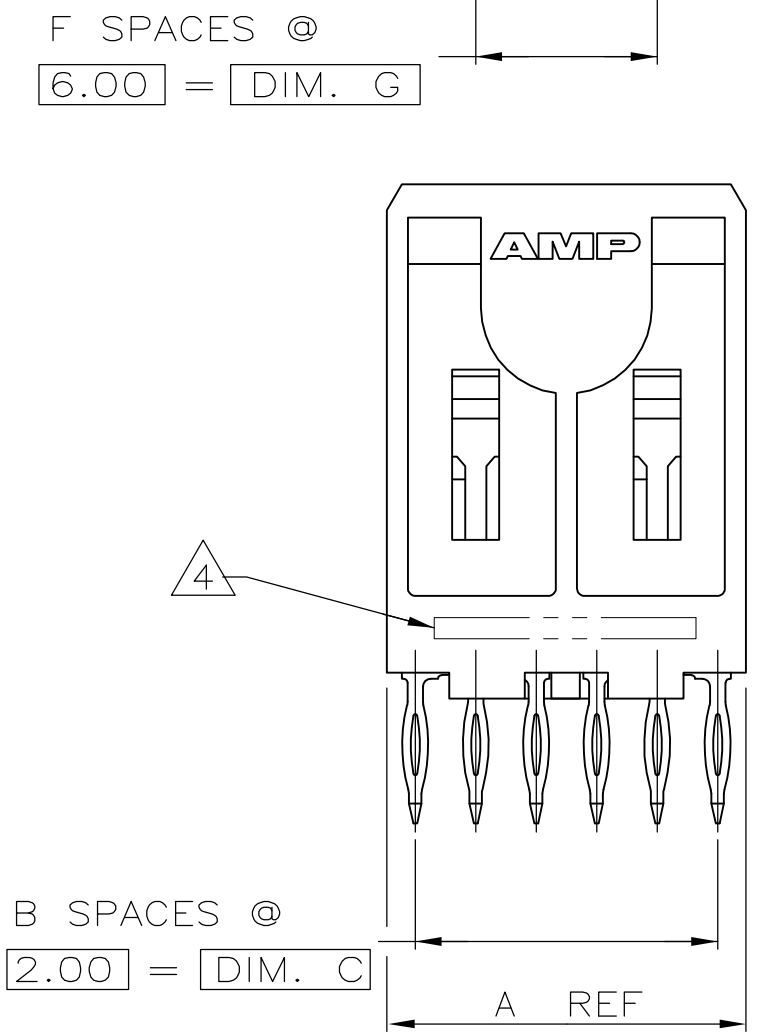
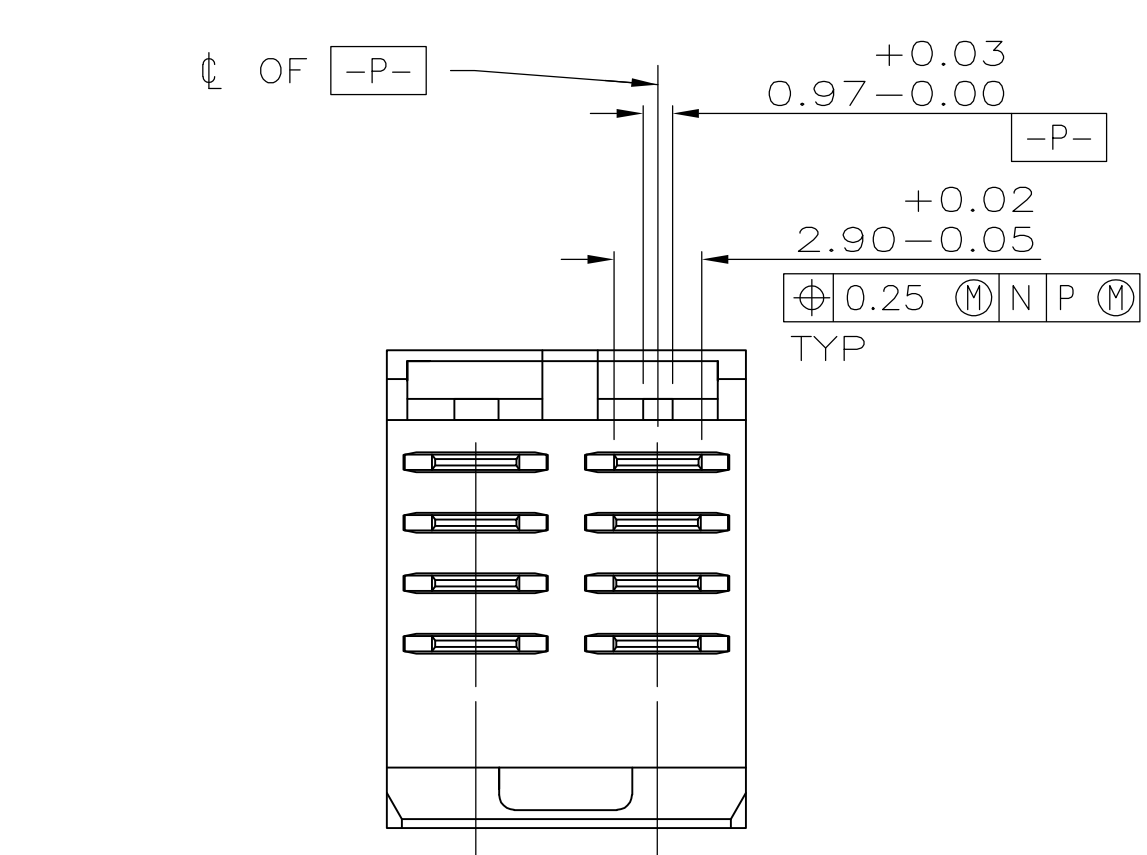

ROW	D	AA	AA
	C	AA	AA
	B	AA	AA
	A	AA	AA
		1	2
		POSITION	

P/N 536603-1

ROW	D	AB	AB
	C	AC	AC
	B	AC	AC
	A	AC	AC
		1	2
		POSITION	

P/N 536603-2

ROW	D	AB	AB
	C	AC	AC
	B	AC	AC
	A	AC	AC
		1	2
		POSITION	

P/N 536603-6

CODE LETTER	MATING POST LENGTH D	LEAD LENGTH (REF)
AA	6.5	4.25
AB	7.25	4.25
AC	8	4.25

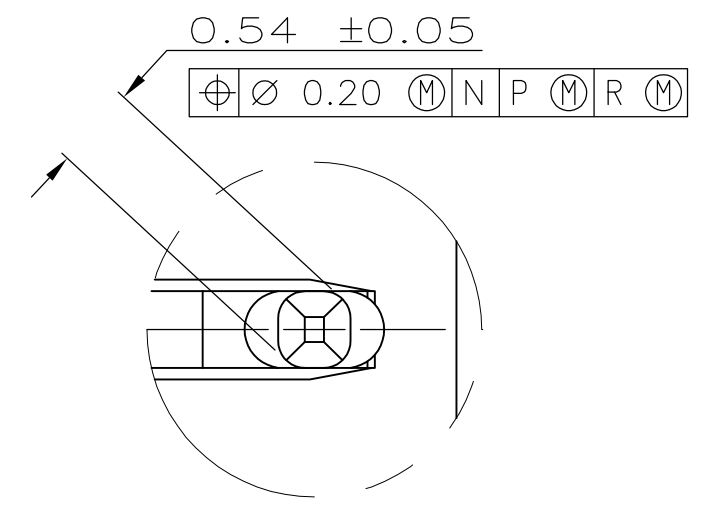

DETAIL Z SCALE 20:1

RECOMMENDED CIRCUIT PATTERN
 PER IPC-D300 TYPE II, CLASS C
 (COMPONENT SIDE)

6.00	1	4.25	10.00	5	11.83	3	8	536603-6
6.00	1	4.25	10.00	5	11.83	3	8	536603-2
6.00	1	4.25	10.00	5	11.83	3	8	536603-1
G	F	E	C	B	A	FINISH	NO OF POSN	PART NUMBER

THIS DRAWING IS A CONTROLLED DOCUMENT.

DIMENSIONS: mm	TOLERANCES UNLESS OTHERWISE SPECIFIED:	DIN J. LOCONDRO 10/19/92	Tyco Electronics Corporation
0. PLC ± -	1. PLC ± -	CHK D. BAECHTLE 02/18/93	Harrisburg, PA 17105-3608
2. PLC ± 0.13	3. PLC ± -	APVD	NAME
4. PLC ± -	ANGLES ± -	PRODUCT SPEC	PIN ASSEMBLY, POWER MODULE, 2mm CENTERLINE, 4 ROW, PRESS FIT CONTACTS.
MATERIAL	FINISH	APPLICATION SPEC	SIZE CASE CODE DRAWING NO
		WEIGHT	A1 00779 C=536603
		CUSTOMER DRAWING	RESTRICTED TO
		SCALE 4:1	SHEET 1 of 1 REV M1