

PRODUCT NUMBER	PITCH
V7xx71x000J0G	5.00 mm

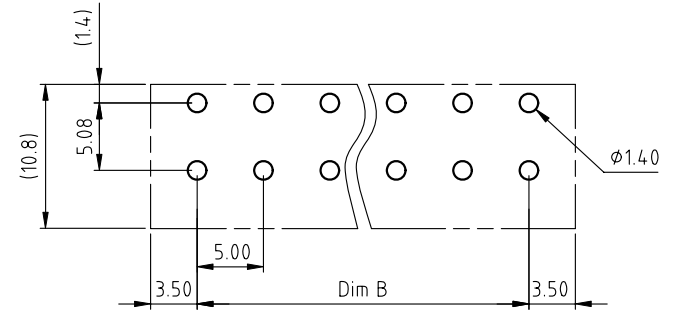

RECOMMENDED P.C.B LAYOUT
TOP VIEW

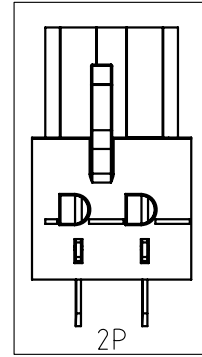
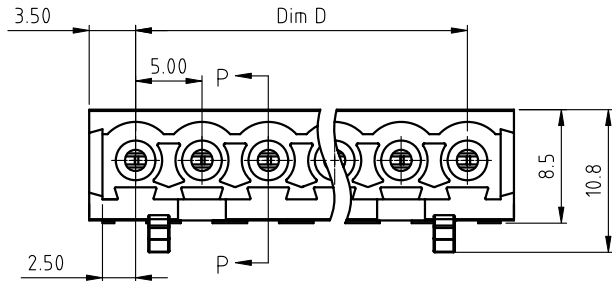
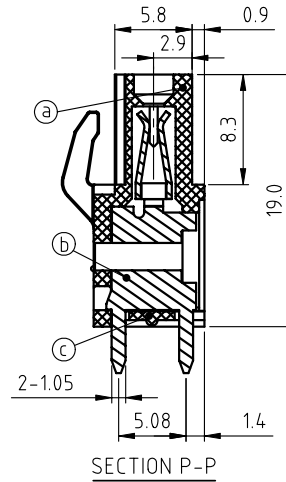
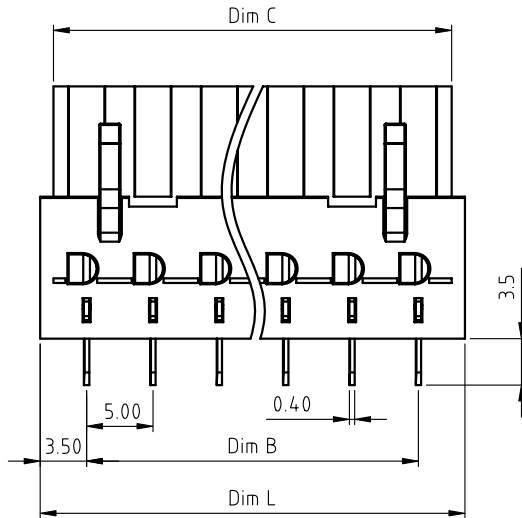

Material:

- Item ① Terminal body: Thermoplastic (UL94V-0)
- Item ② Female contact: PhBz(CuSn), Tin plated
- Item ③ Terminal cover: Thermoplastic (UL94V-0)

Electrical cULus

- Voltage rating: 300VAC
- Current rating: 10A
- Withstanding Voltage: 1.6kv
- Operating temperature: -40°C to +115°C
- Soldering temperature: 260°C±5°C/5 Sec
- Safety Approval:

PART NO.: V7 xx 7 1 x 0 00J0 G

DIM		TOL				
		2P-5P	6P-10P	11P-15P	16P-20P	21P-24P
Dim L	Nx5.0+2.0	±0.15	±0.20	±0.25	±0.30	±0.40
Dim B	(N-1)×5.0	±0.15	±0.20	±0.25	±0.30	±0.40
Dim C	N×5.0	0 -0.20		0 -0.30		
Dim D	(N-1)×5.0	±0.15	±0.20	±0.25	±0.30	±0.40

- Solid block Color RoHS compliant (lead<4%)
 No. of poles In copper Alloy
- 0 Black (RAL9005)
 - 2 Red (RAL3001/D)
 - 3 Orange(RAL2011/P)
 - 4 Yellow(RAL1018/A)
 - 5 Green(RAL6018/T)
 - 6 Blue (RAL5015/A)
 - 8 Grey(RAL7035/D)
 - 9 White(RAL1102)
 - C Green(RAL6018/U)

mat'l. code		surface ASME Y14.5	tolerance ASME Y14.5	projection 	product family TERMINAL BLOCK
ltr	ecn no	dr	date	tolerances unless otherwise specified	title TERMINAL BLOCK
				angles X±0.5	MM ←→
				flatness X.X±0.3	scale PLUGGABLE PCB PLUG,VERTICAL
				total runout X.XX±0.1	dwg no V7xx71x000J0G
		dr	EVIN ZHONG	043014	sheet 1 of 1
		enrg	EVIN ZHONG	043014	size A4
		chr	HANKE FENG	043014	type CUSTOMER Drawing
		appd	SHI JUN	043014	
sheet index	revision	A			
	sheet	1			