

## SmartRack 42U Standard-Depth Rack Enclosure Cabinet with Clear Acrylic Window

MODEL NUMBER: SR42UBG

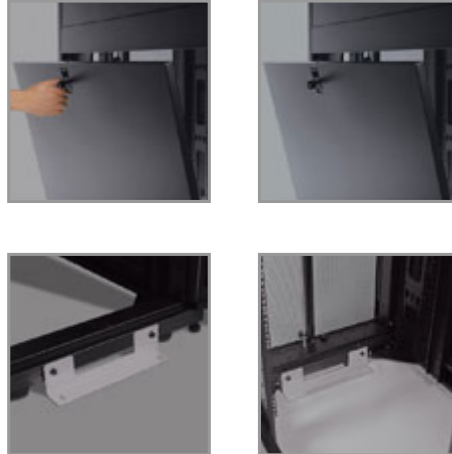

Cabinet secures and organizes 42U of 19-inch rack equipment in network closets, server rooms, data centers and other locations. Clear acrylic window allows you to monitor equipment without unlocking door.

### Description

The SR42UBG SmartRack 42U Standard-Depth Rack Enclosure Cabinet is ideal for storing EIA-standard 19-inch rack equipment in network closets, server rooms, data centers and other areas with limited floor space where you need equipment to be secure and organized. Constructed from heavy-duty steel with a durable black powder-coated finish, the cabinet has a maximum stationary load capacity of 3000 pounds.

The front door features a full-length shatter-resistant clear acrylic window that lets you monitor equipment without unlocking the enclosure. Not only does the window help prevent equipment tampering and reduce acoustic noise, but it also adds visual flair to your IT installation.

To ensure your valuable equipment stays secure, the removable side panels, split rear door and reversible front door lock. The rear door and removable top panel are vented, which allows air to flow freely through the cabinet to keep equipment cool. Convenient top ports and an open bottom allow easy cable routing through the cabinet.

The SR42UBG comes partially assembled and ready to deploy with preinstalled casters that let you easily maneuver it into position, where it can be secured by adjusting the removable levelers. Square mounting holes and numbered rack spaces make equipment installation easy. The vertical mounting rails adjust in 1/4-inch increments to accommodate equipment up to 37 inches deep, such as servers and networking switches.

### Features

#### Secures and Organizes Important Equipment

- Perfect for network closets, server rooms, data centers and other areas with limited floor space where

### Highlights

- Maximum stationary load capacity of 3000 lb.
- Front door includes shatter-resistant clear acrylic window
- Locking steel cabinet vented at rear and top
- Secures 42U of 19 in. rack equipment up to 37 in. deep
- Ships assembled for quick and easy deployment

### Package Includes

- SR42UBG SmartRack 42U Standard-Depth Rack Enclosure Cabinet
- (50) M6 screws
- (50) M6 cage nuts
- (50) M6 washers
- (2) Keys
- Owner's manual

you need equipment to be secure and organized

- Houses EIA-standard 19 in. rack equipment in 42U of space
- Maximum stationary load capacity of 3000 lb.
- Maximum rolling load capacity of 2250 lb.
- Doors and side panels lock securely
- Vented rear and top panels allow generous airflow that keeps equipment cool

#### **Shatter-Resistant Clear Acrylic Front Window**

- Lets you monitor equipment without unlocking the enclosure
- Prevents equipment tampering
- Reduces acoustic noise
- Provides extra visual flair

#### **Convenient Access to Components and Cabling**

- Integrated cable management system helps to eliminate unnecessary airflow obstruction and keep the cabinet more organized
- Removable, split side panels provide easy access for inspection and maintenance
- Split rear door reduces clearance requirements for service access, allowing the enclosure to be placed closer to a wall
- Top ports and open bottom allow cable routing through the cabinet
- Top panel removes toollessly to provide access without disconnecting cables

#### **Ships Partially Assembled for Quick Deployment**

- Preinstalled casters enable the enclosure to be easily maneuvered to desired location
- Removable levelers adjust to stabilize the rack on uneven surfaces

#### **Easy Equipment Installation**

- Vertical mounting rails adjust in 1/4 in. increments to house equipment up to 37 in. deep
- Rails adjust easily—unscrew them, slide them to desired depth, and screw them back in
- Rails support square-hole mounting
- Rack spaces numbered for easy reference
- 0U mounting slots for quick installation of compatible PDUs and vertical cable managers

#### **Meets Payment Card Industry Standards**

- Provides physical equipment and media security required for PCI DSS (Payment Card Industry Data Security Standard) compliance

## **Specifications**



**Tripp Lite**  
1111 W. 35th Street  
Chicago, IL 60609 USA  
Telephone: 773.869.1234  
www.tripplite.com

<b>OVERVIEW</b>	
UPC Code	037332148711
<b>PHYSICAL</b>	
Rack Height (U Spaces)	42
Maximum Device Depth (in.)	37
Maximum Device Depth (cm)	93.98
Minimum Device Depth (in.)	4
Minimum Device Depth (cm)	10.16
Shipping Dimensions (hwd / in.)	79.50 x 46.00 x 29.50
Shipping Dimensions (hwd / cm)	201.93 x 116.84 x 74.93
Shipping Weight (lbs.)	336.00
Shipping Weight (kg)	152.41
Unit Dimensions (hwd / in.)	78.5 x 23.63 x 43
Unit Dimensions (hwd / cm)	199.39 x 60.02 x 109.22
Unit Weight (lbs.)	286
Unit Weight (kg)	129.73
Color	Black
Weight Capacity - Stationary (lbs.)	3000
Weight Capacity - Rolling (lbs.)	2250
Weight Capacity - Stationary (kg)	1,361
Weight Capacity - Rolling (kg)	1,021
Factory Preset Rack Depth (in.)	27.75
Factory Preset Rack Depth (cm)	70.5
Factory Preset Rack Depth (mm)	705
Maximum Device Depth (mm)	940
Minimum Device Depth (mm)	102
<b>SPECIAL FEATURES</b>	
Grounding Lug	Front and Back door frames
<b>CERTIFICATIONS</b>	
Certifications	UL60950; RoHS; CE
Approvals	EIA/ECA-310-E
<b>WARRANTY</b>	



**Tripp Lite**  
1111 W. 35th Street  
Chicago, IL 60609 USA  
Telephone: 773.869.1234  
[www.tripplite.com](http://www.tripplite.com)

Product Warranty Period (Worldwide)	5-year limited warranty
--	-------------------------

© 2018 Tripp Lite. All rights reserved. All product and company names are trademarks or registered trademarks of their respective holders. Use of them does not imply any affiliation with or endorsement by them. Tripp Lite has a policy of continuous improvement. Specifications are subject to change without notice. Tripp Lite uses primary and third-party agencies to test its products for compliance with standards. See a list of Tripp Lite's testing agencies:  
<https://www.tripplite.com/products/product-certification-agencies>