

THIS DRAWING IS A CONTROLLED DOCUMENT.

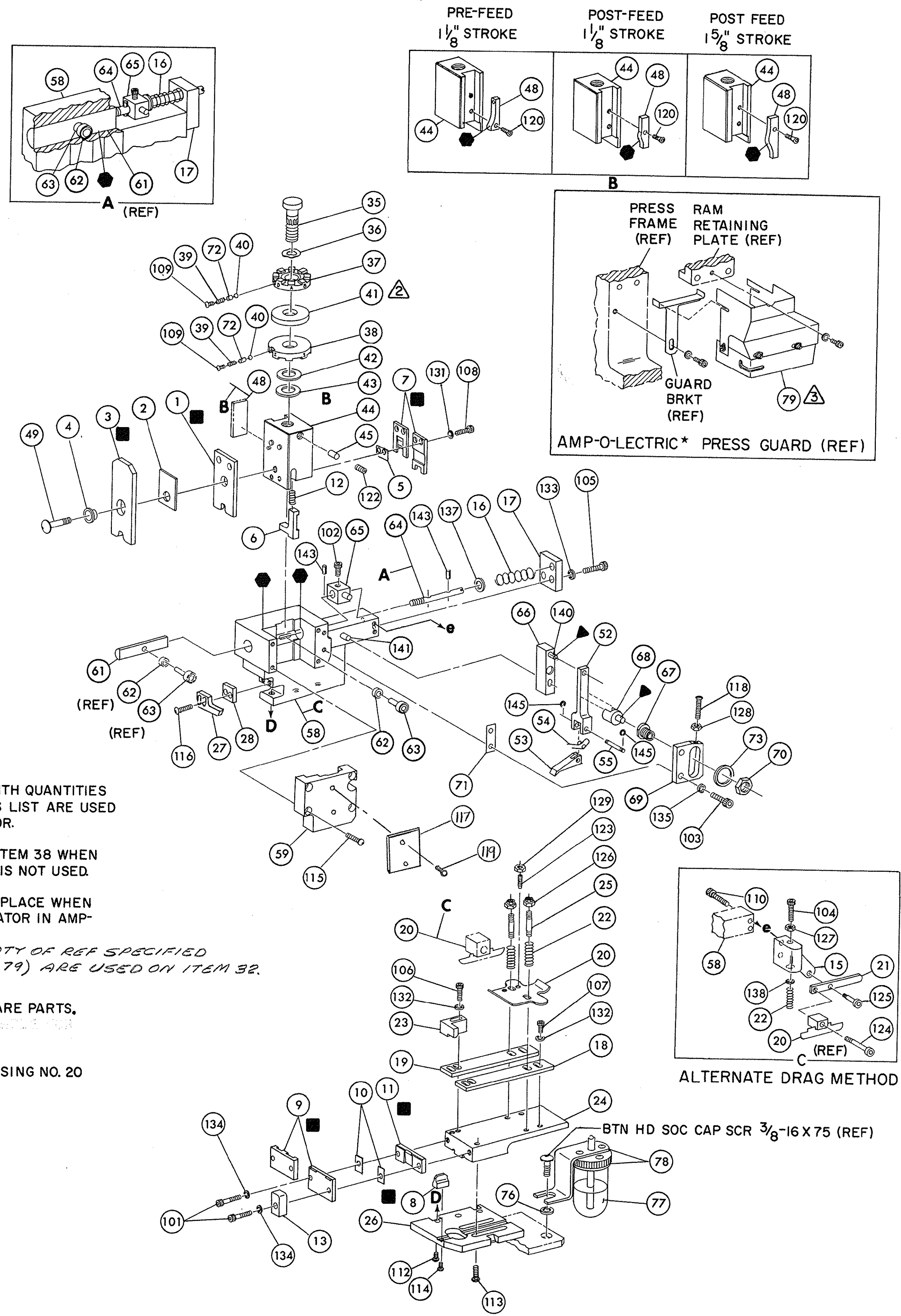

- NOTES:**
- ONLY THE ITEMS WITH QUANTITIES SPECIFIED ON PARTS LIST ARE USED ON THIS APPLICATOR.
  - USED IN PLACE OF ITEM 38 WHEN INSULATION CRIMP IS NOT USED.
  - GUARD MUST BE IN PLACE WHEN OPERATING APPLICATOR IN AMP-O-LECTRIC PRESS.
  - PARTS WITH QTY OF REF SPECIFIED (EXCEPT ITEM 79) ARE USED ON ITEM 32.
- KEY:**
- RECOMMENDED SPARE PARTS.
  - LUBRICATE DAILY USING NO. 20 MACHINE OIL.
  - GREASE LIGHTLY.

REF	QTY	PART NO	DESCRIPTION	ITEM NO
REF		21045-3	RING, RETAINING 'C' (.187 DIA) FEED PIN	145
REF		5-21028-1	PIN, SLOT SPG (.12 DIA X .50) FD ADJ ROD	144
REF		1-21030-7	PIN, DOWEL (.187 DIA X 1.50) HOUSING	143
REF		1-21030-1	PIN, DOWEL (.187 DIA X .50) LEVER	142
		22260-5	WASHER, FLAT (NO 6) DRAG SPRING	141
REF		21899-4	WASHER, FLAT (5/16 DIA) SCR ADJ	140
REF		21024-5	WASHER, LOCK (NO 10) FEED ADJ PLATE	139
2		21024-5	WASHER, LOCK (NO 10) SHEAR PLATES	138
REF		21024-5	WASHER, LOCK (NO 10) FEED ROD GUIDE	137
5		21024-4	WASHER, LOCK (NO 8) STRIP GUIDE	136
2		21024-4	WASHER, LOCK (NO 8) SHEAR BLADE	135
2		21018-4	NUT, HEX MACH (4-40) DRAG	134
REF		21068-5	NUT, HEX MACH (6-32) FD ADJ PLATE	133
		21018-7	NUT, HEX MACH (10-32) DRAG SPRING	132
2		21022-2	NUT, HEX SELF-LKG (8-32) DRAG STUD	131
		5-21004-7	SCR, SKT HD SHLD (250 DIA X .25) DRAG ARM	130
		21004-5	SCR, SKT HD SHLD (250 DIA X 1.00) DRAG	129
2		4-21078-8	SCR, SKT SET OVAL POINT (4-40 X .75) DRAG	128
1		21009-2	SCR, SKT SET (1/4-20 X 25) (LOC-WEL) RAM	127
1		2-21003-0	SCR, FLAT HD SKT CAP (6-32 X .50) CAM	126
2		21017-2	SCR, DRIVE (#2 X .19) I.D. PLATE	125
REF		3-21064-2	SCR, RD HD MACH (6-32 X 1.50) FEED ADJ	124
1		461264-1	PLATE, IDENTIFICATION	123
2		2-21002-2	SCR, BTN HD SKT CAP (8-32 X .50) STRIPPER	122
REF		2-21002-9	SCR, BTN HD SKT CAP (10-32 X .75) HSG CAP	121
1		22733-8	SCR, BTN HD SKT CAP (8-32 X .38) (LOC-WEL) ANVIL	120
4		3-21002-3	SCR, BTN HD SKT CAP (1/4-20 X .50) STR GDE PL	119
REF		1-24073-9	SCR, BTN HD SKT CAP (1/4-20 X .75) BASE PL	118
		2-21000-4	SCR, SKT HD CAP (6-32 X 1.00) DRAG ADAPTOR	117
2		23030-1	SCR, SKT HD CAP (6-32 X .25) (LOC-WEL) CP DISC	116
2		2-21000-6	SCR, SKT HD CAP (8-32 X .38) SHEAR BLADE	115
3		7-21000-4	SCR, SKT HD CAP (8-32 X .31) STRIP GUIDE	114
2		2-21000-9	SCR, SKT HD CAP (8-32 X .75) STRIP GUIDE	113
REF		3-21000-7	SCR, SKT HD CAP (10-32 X .75) FD ROD GUIDE	112
		3-21000-9	SCR, SKT HD CAP (10-32 X 1.00) DRAG SPRING	111
REF		3-21000-6	SCR, SKT HD CAP (10-32 X .62) FD ADJ PLATE	110
REF		3-21000-4	SCR, SKT HD CAP (10-32 X .38) PIVOT BLK	109
2		3-21000-8	SCR, SKT HD CAP (10-32 X .88) SHEAR PLATE	108
REF		455745-1	GUARD, WINDOW	107
		465184-9	LUBRICATOR ASSY	106
		455985-1	OIL, LUBRICATING	105
		454406-1	SPACER, LUB BRACKET	104
REF		458109-1	WASHER, FLAT (SPECIAL)	103
2		690603-1	SPRING, ASSIST	102
REF		690517-1	SPACER	101
		22594-8	NUT, HEX	100
		240628-1	PLATE, ADJ	99
		240626-1	SHAFT, PIVOT	98
		240633-1	BUSHING	97
		455680-1	LEVER, INTERMEDIATE	96
		240629-1	BLOCK, PIVOT	95
		240632-2	SCREW, ADJ	94
		240659-3	PIN, CAM ROLLER	93
		240658-1	CAM, ROLLER	92
REF		454398-1	ROD, FEED	91
REF		454220-1	CAP, RAM	90
REF		453736-1	HOUSING	89
		240624-1	PIN, FEED FINGER	88
REF		691499-1	SPRING, FEED FINGER	87
REF		240635-1	FINGER, FEED	86
REF		240634-1	LEVER, TERMINAL	85
		7-21002-9	BOLT, CRIMPER	84
1		690602-5	CAM, PRE FEED 1/8 STROKE	83
		690191-1	PLUG, NYLON	82
1		455674-1	RAM	81
1		690125-1	WASHER, LAMINATED	80
1		690124-9	WASHER, RAM	79
		23241-6	SPACER, DISC	78
2		690170-1	BALL, STEEL	77
1		690142-1	SPRING, COMPRESSION	76
1		3-692155-3	DISC, INSULATION	75
1		22480-5	DISC, WIRE	74
1		690212-1	WASHER, SPRING	73
		455678-3	POST, RAM	72
		458980-1	APPLICATOR, BASIC (SUB ASSY)	71
		3-690451-2	SPACER, STRIPPER	70
		240639-1	STRIPPER	69
		455676-1	PLATE, BASE	68
		22354-8	DRAG, STUD	67
		455678-3	PLATE, STRIP GUIDE	66
		240825-1	PLATE, STRIP HOLD	65
		4-22281-1	SPRING, DRAG	64
		240636-1	LEVER, DRAG	63
		454177-1	DRAG, STOCK	62
		454204-1	GUIDE, STRIP (REAR)	61
		454204-1	GUIDE, STRIP (FRONT)	60
REF		454178-1	GUIDE, FEED ROD	59
REF		4-22284-9	SPRING, FEED RETURN	58
			ADAPTER, DRAG	57
			SPACER, HOLD DOWN	56
			SPRING, HOLD DOWN	55
			PLATE, REAR SHEAR	54
			SPACER, SHEAR PLATE	53
			PLATE, FRONT SHEAR	52
			ANVIL	51
			BLADE, SLUG	50
			HOLD DOWN, TERMINAL	49
			SPACER, SHEAR BLADE	48
			SPACER, TUBULAR	47
			CRIMPER, INSULATION	46
			SPACER, INSULATION	45
			CRIMPER, WIRE	44

CRIMPING DATA				APPLICATOR WILL APPLY	
PAD LTR	CRIMP HEIGHT	WIRE SIZE	WIRE STRIP LENGTH		
A	.058	16			61408
B	.048	18			62968
C	.044	20			
D	NOT USED				
CRIMP	SIZE	TYPE	FEED	APPL INST	
WIRE	.070	F			
INSUL	.090	F	.705	A18039	
WIRE RANGE	20-16	INSULATION RANGE	.060-.100	PRESS NO	565435-5

REMARKS	NO	REV
APPL USED ON MACHINE PART NO	MACH SERIAL NO	DISTRIBUTION
CUSTOMER NAME	APPL SERIAL NO	ORIGINAL
ADDRESS	PURCHASE ORDER	CUSTOMER COPY
CITY	ENG APP	FIELD ENG COPY

AMP INCORPORATED Harrisburg, Pa.

AMP O-LECTRIC PRE FEED

MINIATURE QUICK CHANGE APPLICATOR

END FEED (.110 EASTON)

REV 1 466141-2

AMP 3076-2 (8-73)