

Crimp contact - SF-10KS320 - 1607031

Please be informed that the data shown in this PDF Document is generated from our Online Catalog. Please find the complete data in the user's documentation. Our General Terms of Use for Downloads are valid (<http://download.phoenixcontact.com>)



Crimp contact, Rolled, Taped articles, Contact diameter: 1 mm, Crimp range: 0.06 mm²...0.25 mm²



Key commercial data

Packing unit	1 1
Weight per Piece (excluding packing)	0.2 GRM
Custom tariff number	85389099
Country of origin	Germany

Technical data

General

Contact type	Rolled
Contact diameter	1 mm
Contact type	Socket
Connection type	Crimp connection
Insertion/withdrawal cycles mechanical	500
Litz wire cross section min.	0.06 mm ²
Litz wire cross section max.	0.25 mm ²

Classifications

eCl@ss

eCl@ss 4.0	272607xx
eCl@ss 4.1	27260701
eCl@ss 5.0	27260701
eCl@ss 5.1	27260701
eCl@ss 6.0	27260708

Crimp contact - SF-10KS320 - 1607031

Classifications

eCl@ss

eCl@ss 7.0	27440312
eCl@ss 8.0	27440312

ETIM

ETIM 3.0	EC001121
ETIM 4.0	EC000796
ETIM 5.0	EC000796

UNSPSC

UNSPSC 6.01	43172015
UNSPSC 7.0901	43201404
UNSPSC 11	43172015
UNSPSC 12.01	43201404
UNSPSC 13.2	43201404

Approvals

Approvals

Approvals

GOST

Ex Approvals

Approvals submitted

Approval details

GOST 
--

Accessories

- Accessories
- Crimping tool

Crimp contact - SF-10KS320 - 1607031

Accessories

Crimping pliers - SF-Z0029 - 1607458



Crimping pliers

Electrical crimping tool - SF-Z0032 - 1607462



Electrical crimping tool

Drawings

Dimensioned drawing

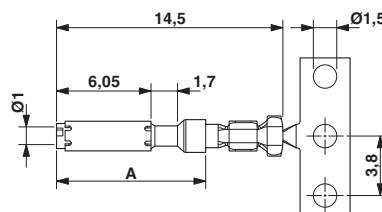

A = D-SUB dimensions