

REV.	DATE	ECR NO.	DESCRIPTION
A	05/02/12	2309	UPDATE DRAWING FORMAT

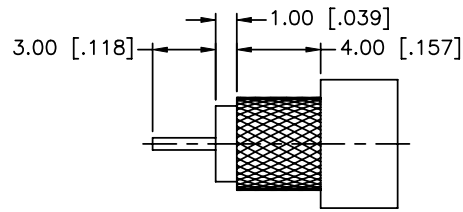

RECOMMENDED  
CABLE STRIPPING DIM'S

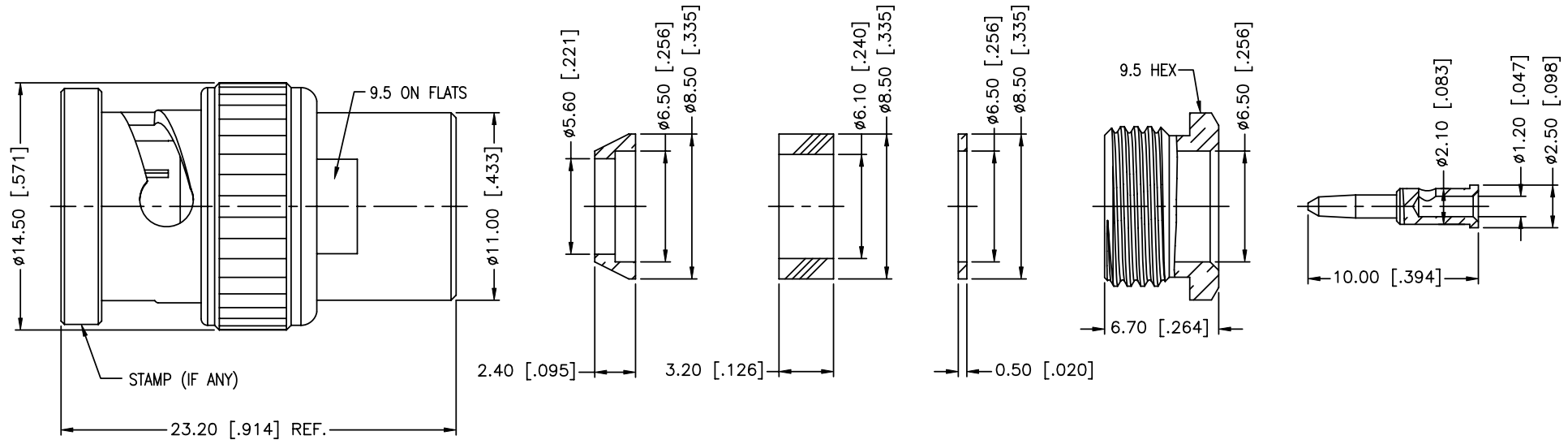

12	CONTACT PIN	BRASS	GOLD	1
11	HEX NUT	BRASS	NICKEL	1
10	WASHER	BRASS	NICKEL	1
9	GASKET	SILICONE	RED	1
8	TOP HAT	BRASS	NICKEL	1
7	WASHER	BRASS	NICKEL	1
6	SPRING	SK5	NICKEL	1
5	RETAINER RING	BRASS	NICKEL	1
4	GASKET	RUBBER	RED	1
3	INSULATOR	DELTRIN	NATURAL	1
2	BODY	BRASS	NICKEL	1
1	SHELL	BRASS	NICKEL	1
	DESCRIPTION	MATERIAL	FINISH	QTY

UNLESS OTHERWISE SPECIFIED DIMENSIONS ARE IN MILLIMETERS. DIMENSIONS IN [ ] ARE IN INCHES AND FOR CUSTOMER REFERENCE ONLY.

UNLESS OTHERWISE SPECIFIED TOLERANCES FOR MILLIMETERS ARE:  
0.5 - 8mm ± 0.20mm  
8 - 30mm ± 0.40mm  
30 - 120mm ± 0.50mm

UNLESS OTHERWISE SPECIFIED TOLERANCES FOR INCHES ARE:  
.020 - .315 = ± 0.007"  
.315 - 1.180 = ± 0.015"  
1.180 - 4.724 = ± 0.020"

DO NOT SCALE DRAWING

APPROVALS	DATE
DRAWN R.MAO	05/02/12
CHECKED	
ISSUED	
SHEET 1 OF 1	
CAD FILE	C:/CONNEX/112350.DWG

<b>Amphenol Connex</b>			
PART DESCRIPTION <b>BNC CLAMP PLUG FOR RG-59/U TYPE CABLE</b>			
PART NO. <b>112350</b>			
DWG. NO.	112350.DWG	REV.	A
SIZE	A	SCALE	NA

1. CRIMPED CONTACT PIN  
HEX CRIMP SIZE .068"