

PART NUMBER	REV	FIRST USED
466791-1	D	122500-1
466791-2	D	565435-5
466791-3	D	354500-1

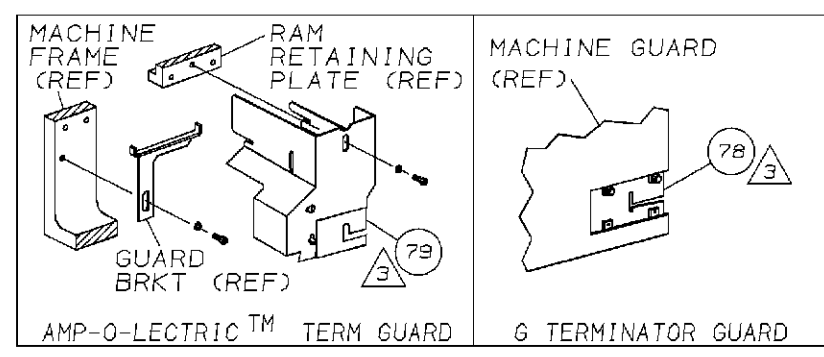

TERMINAL NAME: .250 BLADE RECEPTACLE			
640841			
CRIMPING DATA			
PAD LTR	CRIMP HEIGHT	WIRE SIZE	
A	.072 ±.002 [1.83 ±0.05mm]	16	
B	.064 ±.002 [1.63 ±0.05mm]	18	
C	.061 ±.002 [1.55 ±0.05mm]	20	
D	NOT	USED	
CRIMP	SIZE	TYPE	RANGE
WIRE	.090 [2.29mm]	F	20 - 16
INSUL	.180 [4.57mm]	0	.145 MAX
WIRE STRIP LENGTH	TERM APPL SPEC	FEED	APPL INSTRUCTION
-	114-1026	.690	408-8040
			SET UP GAGE LAYOUT
			458637-1 1044

LEADMAKER		MECH POST FEED	
BENCH MODEL	K	MECH PRE FEED	
BENCH MODEL	G	MECH PRE FEED	
1	1	1	- B 22594-8 NUT, HEX (1/2-20) 70
1	1	1	- B 240628-1 PLATE, ADJUSTMENT 69
1	1	1	- B 240626-1 SHAFT, PIVOT 68
1	1	1	- B 240633-1 BUSHING 67
1	1	1	- A 455680-1 LEVER, INTERMEDIATE 66
1	1	1	- B 240629-1 BLOCK, PIVOT 65
1	1	1	- A 240632-2 SCREW, ADJ FEED ROD 64
1	1	1	- B 240659-3 PIN, CAM ROLLER 63
1	1	1	- B 240658-1 ROLLER, CAM 62
1	1	1	- B 454398-2 ROD, FEED 61
1	1	1	- A 454178-1 GUIDE, FEED ROD 60
1	1	1	- C 454220-1 CAP, RAM 59
1	1	1	- D 454485-1 HOUSING 58
1	1	1	- B 458537-2 PAWL, FEED 56
1	1	1	- B 240624-1 PIN, FEED FINGER 55
1	1	1	- B 691499-1 SPRING, FEED FINGER 54
1	1	1	- A 690541-1 HOLDER, FEED FINGER 53
1	1	1	- B 455679-1 LEVER, TERMINAL FEED ARM 52
1	1	1	- A 811242-2 BUMPER, HOLDDOWN 51
1	1	1	- A 690753-1 SPACER, TONKER 50
1	-	-	- B 690602-6 CAM, PRE-FEED 1 5/8 ST 49
-	1	-	- B 690602-5 CAM, PRE-FEED 1 1/8 ST 48
-	-	1	- B 690501-4 CAM, POST-FEED 1 5/8 ST 47
1	1	1	- A 690191-1 PLUG, NYLON 45
1	1	1	- C 455673-1 RAM 44
1	1	1	- A 690125-1 WASHER, LAMINATED 43
1	1	1	- A 690124-1 WASHER, RAM 42
1	1	1	- A 7-21002-9 BOLT, CRIMPER (5/16x1.00) 41
1	1	1	- A 23241-6 BALL, STEEL 40
1	1	1	- A 690170-1 SPRING, COMPRESSION 39
1	1	1	- C 690142-1 DISC, INSULATION 38
1	1	1	- D 354777-1 WIRE DISC, PLASTIC 37
1	1	1	- A 22480-5 WASHER, SPRING 36
1	1	1	- B 690212-1 POST, RAM 35
1	1	1	- B 690786-1 SUPPORT, TERMINAL 34
1	1	1	- D 455675-1 PLATE, BASE 33
1	1	1	- A 690432-3 SCREW, ADJUSTMENT 32
1	1	1	- B 455689-1 BLOCK, STRIP GUIDE ADJ 30
1	1	1	- C 455671-2 PLATE, STRIP GUIDE 29
1	1	1	- C 1-455688-0 SPACER, FRONT SHEAR DEP 28
2	2	2	- A 1-22284-0 SPRING, DRAG 27
1	1	1	- B 690546-1 LEVER, DRAG RELEASE 26
1	1	1	- B 240792-1 DRAG, TERMINAL 25
1	1	1	- D 4-690504-4 GUIDE, STRIP (REAR) 24
1	1	1	- A 690438-1 GUIDE, STRIP (FRONT) 23
-	-	1	- B 690472-2 STRIPPER 22
1	1	1	- A 4-22284-9 SPRING, FEED RETURN 21
1	1	-	- A 679218-1 STRIPPER WIRE STOP ASSY 20
1	1	-	- B 458949-1 STRIPPER 19
1	1	1	- B 318563-1 GUARD, CHIP, FRONT 16
1	1	1	- A 5-22280-0 SPRING, SHEAR 12
1	1	1	- B 690461-7 STOP, SHEAR 11
1	1	1	- C 1-690459-0 HOLDER, SHEAR (FRONT) 10
1	1	1	- C 454276-5 SHEAR, FLOAT (FRONT) 9
1	1	1	- C 8-458834-3 ANVIL 8
1	1	1	- C 1-455889-8 DEPRESSOR, SHEAR (FRONT) 5
1	1	1	- B 238011-8 SPACER, BLOCK CRIMPER 4
1	1	1	- C 456135-3 CRIMPER, INSULATION 3
1	1	1	- C 1-455888-0 SPACER, CRIMPER 2
1	1	1	- C 1-456406-5 CRIMPER, WIRE 1

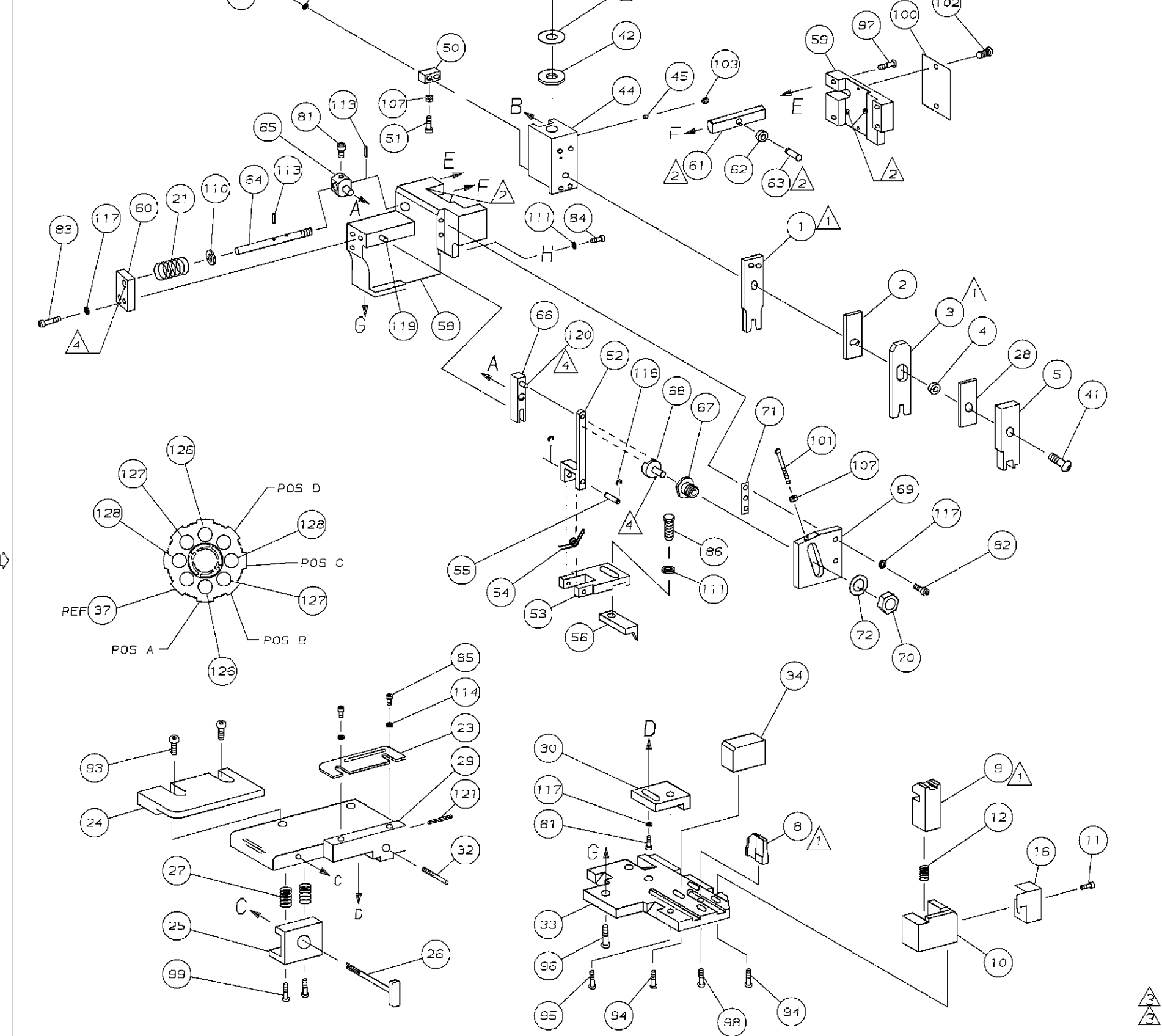

QTY	REQD	PER	ASSY	PART NO	DESCRIPTION	ITEM NO
2	2	2	-	C	9-354778-9	PIN, WIRE DISC (.2990)C 129
2	2	2	-	C	9-354778-3	PIN, WIRE DISC (.2960)B 128
2	2	2	-	C	7-354778-7	PIN, WIRE DISC (.2880)A 126
1	1	1	-	A	986950-1	WASHER, FLAT PRECISION 125
1	1	1	-	A	217238-1	DOCUMENTATION PACKAGE 124
1	1	1	-	-	4088040	SF APPL INST 408-8040 123
1	1	1	-	A	4-21028-0	PIN, SLT SPR (#.093x.75)ST 6DE PL 122
1	1	1	-	A	1-21030-1	PIN, DOWEL (#.187x.50)LEVER 120
1	1	1	-	A	1-21030-6	PIN, DOWEL (#.187x1.25)HOUSING 119
2	2	2	-	A	21045-3	RING, RET "C" (#.187)FD FING PIN 118
5	5	5	-	A	21024-5	WASHER, LOCK (#10)ADJ BLOCK 117
2	2	2	-	A	21024-2	WASHER, LOCK (#4)FRONT STP GUIDE 115
2	2	2	-	A	5-21028-1	PIN, SLT SPR (#.125x.50)ADJ ROD 113
4	4	4	-	A	21024-4	WASHER, LOCK (#8)STRIPPER 111
1	1	1	-	A	21899-4	WASHER, FLAT (#5/16)SCREW ADJ 110
1	2	2	-	A	21018-5	NUT, HEX (6-32)FEED ADJ 107
1	1	1	-	A	992031-1	PIN, CLEVIS 104
1	1	1	-	A	21009-2	SCR, SKT SET (1/4-20x.25 LW)RAM 103
2	2	2	-	A	21017-2	SCR, DRIVE (#2x.19)ID PLATE 102
1	1	1	-	A	6-23715-5	SCR, PAN HD (6-32x1.50)FEED ADJ 101
1	1	1	-	B	461264-1	PLATE, IDENTIFICATION 100
2	2	2	-	A	3-21002-0	SCR, BHC (10-32x.88)DRAG 99
1	1	1	-	A	22733-8	SCR, BHC (8-32x.38 LW)ANVIL 98
2	2	2	-	A	2-21002-9	SCR, BHC (10-32x.75)CAP 97
3	3	3	-	A	2-22733-8	SCR, BHC (1/4-20x.62)HOUSING 96
1	1	1	-	A	2-21002-7	SCR, BHC (10-32x.50)SG ADJ BLOCK 95
4	4	4	-	A	2-21002-2	SCR, BHC (8-32x.50)TERM H DWN 94
2	2	2	-	A	2-21002-3	SCR, BHC (8-32x.62)R STP GDE 93
1	1	1	-	A	1-21002-7	SCR, BHC (6-32x.38)CAM 91
1	1	-	-	A	7-21000-9	SCR, SHC (4-40x.19)STRIPPER 89
1	1	1	-	A	2-22503-0	SCR, HEX HD (8-32x.31)FEED FINGER 86
2	2	2	-	A	1-21000-3	SCR, SHC (4-40x.25)F ST GUIDE 85
3	3	3	-	A	2-21000-7	SCR, SHC (8-32x.50)STRIPPER 84
2	2	2	-	A	3-21000-7	SCR, SHC (10-32x.75)FEED ROD 6D 83
2	2	2	-	A	3-21000-6	SCR, SHC (10-32x.62)FEED ADJ BLK 82
2	2	2	-	A	3-21000-4	SCR, SHC (10-32x.38)SG ADJ BL 81
-	REF	-	-	B	455749-1	GUARD, WINDOW 79
REF	-	-	-	B	679532-1	INSERT, GUARD 78
1	1	1	-	A	690603-1	SPRING, ASSIST 74
1	1	1	-	A	23030-1	SCR, SHC (6-32x.25 SL)INS DISC 73
1	1	1	-	A	458109-1	WASHER, SPECIAL 72
1	1	1	-	A	690517-1	SPACER 71
-3	-2	-1	U/M	DWG SIZE	PART NO	DESCRIPTION

QTY	REQD	PER	ASSY	PART NO	DESCRIPTION	ITEM NO
1	1	1	-	A	2-22503-0	SCR, HEX HD (8-32x.31)FEED FINGER 86
2	2	2	-	A	1-21000-3	SCR, SHC (4-40x.25)F ST GUIDE 85
3	3	3	-	A	2-21000-7	SCR, SHC (8-32x.50)STRIPPER 84
2	2	2	-	A	3-21000-7	SCR, SHC (10-32x.75)FEED ROD 6D 83
2	2	2	-	A	3-21000-6	SCR, SHC (10-32x.62)FEED ADJ BLK 82
2	2	2	-	A	3-21000-4	SCR, SHC (10-32x.38)SG ADJ BL 81
-	REF	-	-	B	455749-1	GUARD, WINDOW 79
REF	-	-	-	B	679532-1	INSERT, GUARD 78
1	1	1	-	A	690603-1	SPRING, ASSIST 74
1	1	1	-	A	23030-1	SCR, SHC (6-32x.25 SL)INS DISC 73
1	1	1	-	A	458109-1	WASHER, SPECIAL 72
1	1	1	-	A	690517-1	SPACER 71
-3	-2	-1	U/M	DWG SIZE	PART NO	DESCRIPTION

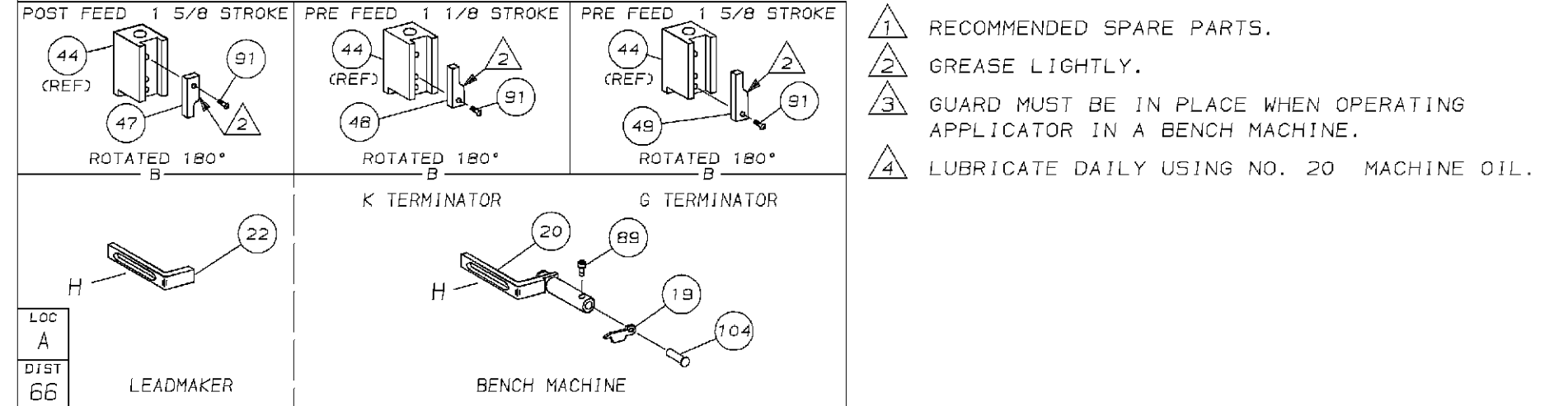

THIS DRAWING IS A CONTROLLED DOCUMENT FOR AMP INCORPORATED. IT IS SUBJECT TO CHANGE AND THE CONTROLLING ENGINEERING ORGANIZATION SHOULD BE CONTACTED FOR THE LATEST REVISION.

THIS INFORMATION IS CONFIDENTIAL AND IS DISCLOSED TO YOU ON CONDITION THAT NO FURTHER DISCLOSURE IS MADE BY YOU TO OTHER THAN AMP PERSONNEL WITHOUT WRITTEN AUTHORIZATION FROM AMP INCORPORATED, HARRISBURG, PA.

466791