

- ① HOUSING MATERIAL: THERMOPLASTIC, BLACK.
- ② CONTACT MATERIAL: COPPER ALLOY.
- ③ CONTACT FINISH: .000050-.000100 NICKEL UNDERPLATE ALL OVER WITH .000030 GOLD IN CONTACT AREA AND .000100-.000200 TIN-LEAD PLATED POSTS.

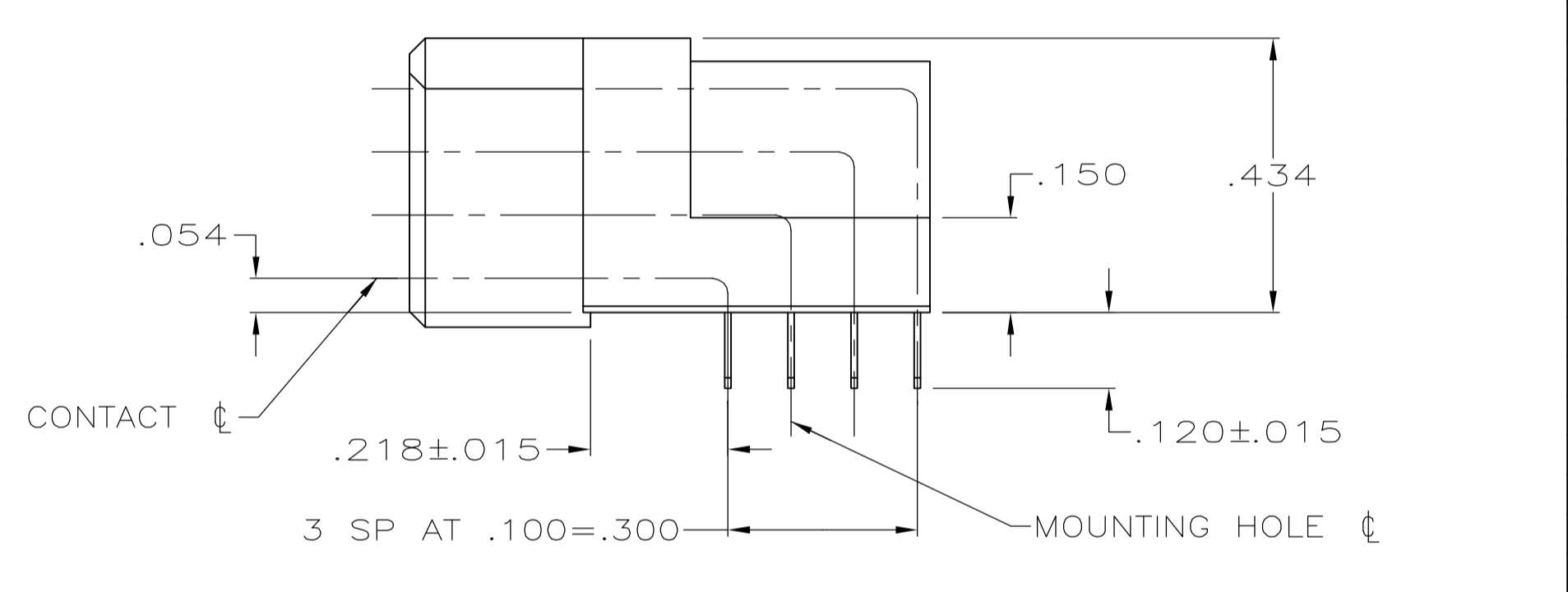

OBSOLETE

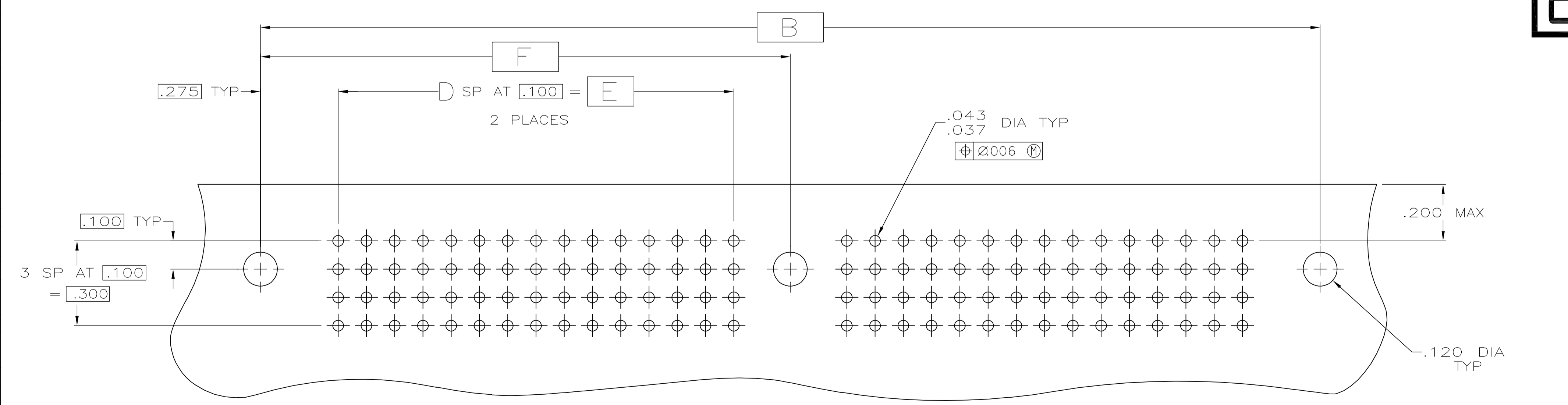

RECOMMENDED P.C. BOARD LAYOUT

3.875	3.400	34	7.324	7.750	8.050	280	534010-8
5.875	5.400	54	11.324	11.750	12.050	440	534010-7
5.025	4.300	43	9.324	9.750	10.050	360	534010-6
5.575	5.100	51	10.724	11.150	11.450	416	534010-5
6.375	5.900	59	12.324	12.750	13.050	480	534010-4
4.975	4.500	45	9.524	9.950	10.250	368	534010-3
4.675	4.200	42	8.924	9.350	9.650	344	534010-2
4.375	3.900	39	8.324	8.750	9.050	320	534010-1
F	E	D	C	B	A	NO OF POSN	PART NUMBER

THIS DRAWING IS A CONTROLLED DOCUMENT.

DIMENSIONS: INCHES	TOLERANCES UNLESS OTHERWISE SPECIFIED:	DIN T. HOFFMAN 08/26/91	tyco Tyco Electronics Corporation Harrisburg, PA 17105-3608
0 PLC ± -	1 PLC ± -	CHK DAVID HOFFMAN 12/10/91	ASSEMBLY, RECEPTACLE, TBC.
2 PLC ± -	3 PLC ± .005	APVD DAVID HOFFMAN 12/10/91	108-1098
4 PLC ± -	ANGLES ± -	NAME	ASSEMBLY, RECEPTACLE, TBC.
		PRODUCT SPEC	4 ROW, 2 MOUNTING HOLES.
		APPLICATION SPEC	1 GUIDE PIN, .120 POST LENGTH
MATERIAL	FINISH	SIZE	RESTRICTED TO
		WEIGHT	A1 00779 C=534010
		CUSTOMER DRAWING	SCALE 4:1 SHEET 1 OF 1 REV M