

NOTES:

1. ALL DIMENSIONS IN MM [INCH]
2. GENERAL TOLERANCE: X.X=±0.4  
X.XX=±0.25
3. TERM NOS. FOR REF. ONLY
4. RATING: 0.4VA @20V max. (AC or DC)
5. CONTACT MATERIAL:  
Copper Alloy w/Gold plate over  
Nickle plate.
6. ELECTRICAL LIFE: 30,000 ACTUATIONS @Full Load
7. INSULATION RESISTANCE: 1000 Mega Ohms min.
8. DIELECTRIC STRENGTH: 1000V RMS @SEA LEVEL.
9. OPERATING TEMPERATURE: -30°C TO 85°C

4.

RECOMMENDED P.C.B. LAYOUT

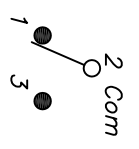
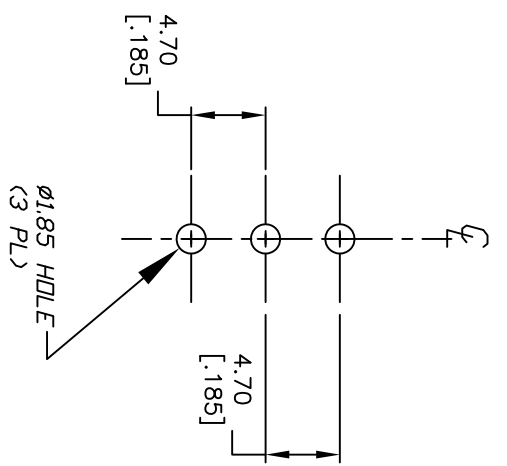

CIRCUIT: SPDT

SWITCH FUNCTION			
PDS. 1	PDS. 2	PDS. 3	
DN	DN	DN	DN
DN	DN	DN	DN
2-1	OPEN	2-3	2-3



C	21400	REVISED	3/10/14	EBP
B	11645	REVISED AND REDRAWN	9/6/01	CJB
REV.	ECN NO.	DESCRIPTION	DATE	CHKD

THE INFORMATION CONTAINED IN THIS DOCUMENT IS PROPRIETARY TO E-SWITCH AND IS NOT TO BE COPIED OR TRANSFERRED

TITLE		SCALE	DATE	DR	DWG	REV
500 SSP-1 S4 M2 R E A (GOLD CONTACTS)		2:1	9/6/01	CJB	T514000	C