

P.C.B MOUNTING

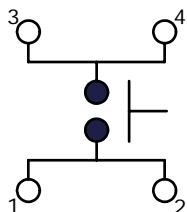

CIRCUIT: SPST

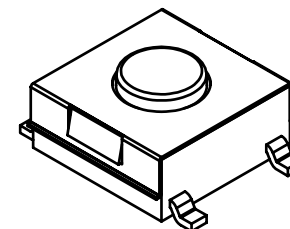
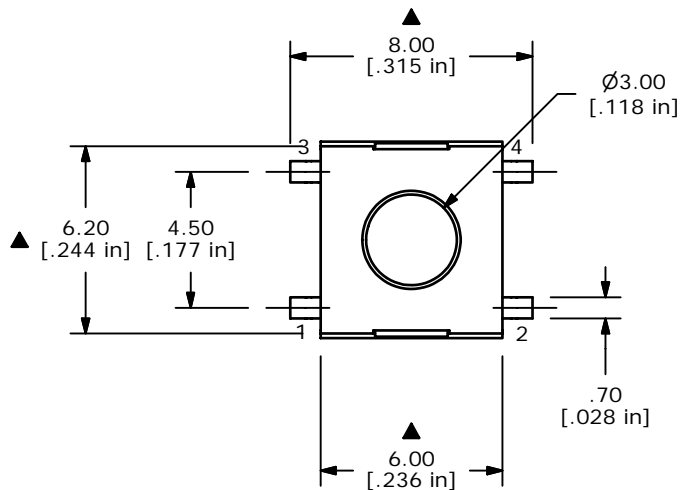

ISOMETRIC

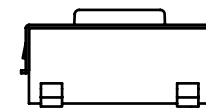
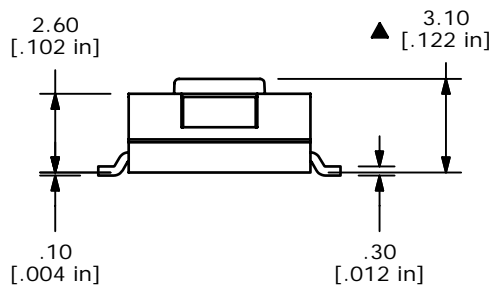

TERMINALS TO BE COLPLANAR WITH IN 0.10mm

NOTES:

1. ALL DIMENSIONS IN MM [INCH]
2. GENERAL TOLERANCE: X.X=±0.4
X.XX=±0.25
3. TERMINAL NUMBERS FOR REF ONLY.
4. TRAVEL: 0.25mm +0.2/-0.1
5. RATING: 50mA, 12VDC
6. OPERATING FORCE: 160±50gf
7. CONTACT RESISTANCE: 100M OHM MAX.
- ▲ 8. ACTUATOR COLOR: IVORY
9. ▲ DENOTES CRITICAL PARAMETER
- ▲ 10. PACKAGING: TAPE AND REEL 1,500 PCS PER
- ▲ 11. 2002/95/EC (ROHS) COMPLIANT

E-SWITCH®

| | | | | |
|-----|--------|----------------------|---------|----|
| C | 17037 | FIXED ACTUATOR COLOR | 2/27/07 | TN |
| B | 15915 | REVISED REDRAWN | 3/29/06 | PH |
| REV | PCR NO | DESCRIPTION | DATE | BY |

| | | | | |
|--------------------|-----------|----|---------|-----|
| TITLE TL3303F160QG | | | | |
| SCALE | DATE | DR | DWG | REV |
| 4:1 | 2/27/2007 | TN | P010428 | C |

THE INFORMATION CONTAINED IN THIS DOCUMENT IS PROPRIETARY TO E-SWITCH AND IS NOT TO BE COPIED OR TRANSFERRED