

1

2

3

4

5

6

7

A

A

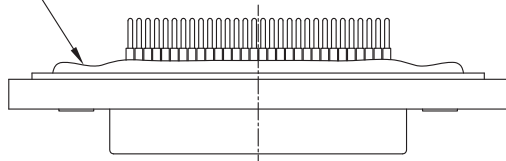
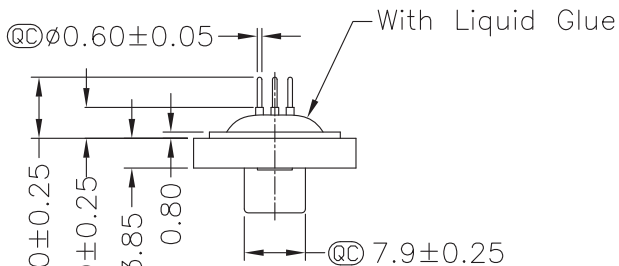

Screw L=5.0 For Panel Thickness Under 1.2mm

Screw L=6.0 For Panel Thickness Between 1.2~2.0mm

B

B

C

C

$\text{QC } 7.90 \pm 0.25$
 $\text{QC } 4.0 \pm 0.25$
 3.85
 0.80

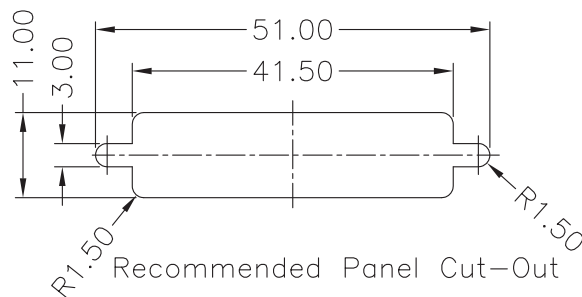
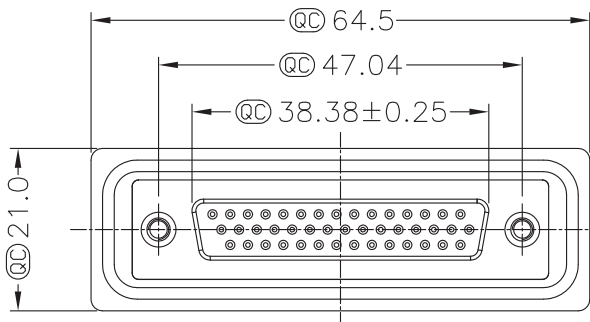

D

D

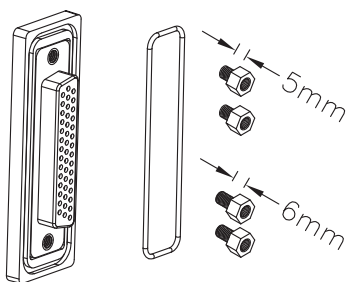

E

E

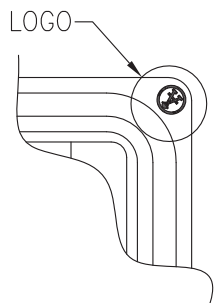

Material:

- Waterproof rate: IP67
- Connector: Black, Nylon+GF
- Pin: Copper alloy, Gold plated

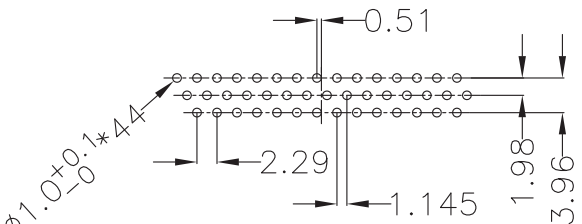

F

F

G

G

Scale	Free				Date	Name	Title
TOLERANCE					Drawn	30.11.11	Chappell
X.X	± 0.25				Approved		
X.XX	± 0.10						
X.XXX	± 0.05						
DIM	TOL						
X.°	$\pm 1^\circ$						
X.X°	$\pm X^\circ$						
Angle	TOL	Id.	Modification	Date	Name		

Title		Waterproof DSub connector High Density, Straight 44 pin, Male	
ASSMANN WSW-No.		A-HDF44PP-WP	
Drawing-No.		rev00	
Replace		Sheet 1/1	

Unit: mm



1840 W. Drake Drive, Suite 101 • Tempe, AZ 85283
 Toll Free: 1-877-277-6266 • Email: info@assmann.us

1

2

3

4

5

6

7

H

H