

# Printed-circuit board connector - MCDN 1,5/ 5-G1-3,81 P26THR - 1749557

Please be informed that the data shown in this PDF Document is generated from our Online Catalog. Please find the complete data in the user's documentation. Our General Terms of Use for Downloads are valid (<http://phoenixcontact.com/download>)



Header, Nominal current: 8 A, Rated voltage (III/2): 160 V, Number of positions: 5, Pitch: 3.81 mm, Color: black, Contact surface: Tin, Mounting: THR soldering, The pin length is 2.6 mm. User information and design recommendations on Through Hole Reflow Technology can be found at: "Downloads"

The figure shows a 10-pos. version with 20 contacts

## Product Features

- Versions with engagement noses for locking plugs with self-locking flanges
- Plug-in direction parallel to the PCB
- Low-profile THR double-level pin strips with compact pitches of 3.5 mm and 3.81 mm
- Use in SMT reflow processes
- Without offset levels, for flush installation on the front of devices



## Key Commercial Data

|                                      |          |
|--------------------------------------|----------|
| Packing unit                         | 1 pc     |
| Minimum order quantity               | 50 pc    |
| Weight per Piece (excluding packing) | 4.0 g    |
| Custom tariff number                 | 85366990 |
| Country of origin                    | Bulgaria |

## Technical data

### Dimensions

|                       |          |
|-----------------------|----------|
| Length                | 13.3 mm  |
| Pitch                 | 3.81 mm  |
| Dimension a           | 15.24 mm |
| Width                 | 20.14 mm |
| Constructional height | 15.2 mm  |
| Height                | 17.8 mm  |

# Printed-circuit board connector - MCDN 1,5/ 5-G1-3,81 P26THR - 1749557

## Technical data

### Dimensions

|                          |              |
|--------------------------|--------------|
| Length of the solder pin | 2.6 mm       |
| Pin dimensions           | 0,8 x 0,8 mm |
| Pin spacing              | 3.50 mm      |
| Hole diameter            | 1.4 mm       |

### General

|  |                    |
|--|--------------------|
| Range of articles                      | MCDN 1,5/...G1-THR |
| Insulating material group              | IIIa               |
| Rated surge voltage (III/3)            | 2.5 kV             |
| Rated surge voltage (III/2)            | 2.5 kV             |
| Rated surge voltage (II/2)             | 2.5 kV             |
| Rated voltage (III/3)                  | 160 V              |
| Rated voltage (III/2)                  | 160 V              |
| Rated voltage (II/2)                   | 250 V              |
| Connection in acc. with standard       | EN-VDE             |
| Nominal current $I_N$                  | 8 A                |
| Maximum load current                   | 8 A (per position) |
| Insulating material                    | LCP                |
| Flammability rating according to UL 94 | V0                 |
| Color                                  | black              |
| Number of positions                    | 5                  |

### Standards and Regulations

|  |        |
|--|--------|
| Connection in acc. with standard       | EN-VDE |
|  | CUL    |
| Flammability rating according to UL 94 | V0     |

## Classifications

### eCl@ss

|            |          |
|------------|----------|
| eCl@ss 4.0 | 272607xx |
| eCl@ss 4.1 | 27260701 |
| eCl@ss 5.0 | 27260701 |
| eCl@ss 5.1 | 27260701 |
| eCl@ss 6.0 | 27260704 |
| eCl@ss 7.0 | 27440402 |
| eCl@ss 8.0 | 27440402 |
| eCl@ss 9.0 | 27440402 |

# Printed-circuit board connector - MCDN 1,5/ 5-G1-3,81 P26THR - 1749557

## Classifications

### ETIM

|          |          |
|----------|----------|
| ETIM 3.0 | EC001121 |
| ETIM 4.0 | EC002637 |
| ETIM 5.0 | EC002637 |

### UNSPSC

|               |          |
|---------------|----------|
| UNSPSC 6.01   | 30211810 |
| UNSPSC 7.0901 | 39121409 |
| UNSPSC 11     | 39121409 |
| UNSPSC 12.01  | 39121409 |
| UNSPSC 13.2   | 39121409 |

## Approvals

### Approvals

---

#### Approvals

VDE Gutachten mit Fertigungsüberwachung / EAC / cULus Recognized / IECEE CB Scheme / EAC

---

#### Ex Approvals

---

#### Approvals submitted

---

### Approval details

|   |       |
|---|-------|
| VDE Gutachten mit Fertigungsüberwachung  |       |
| Nominal current I <sub>N</sub>  | 8 A   |
| Nominal voltage U <sub>N</sub>  | 160 V |

|     |
|-----|
| EAC |
|-----|

# Printed-circuit board connector - MCDN 1,5/ 5-G1-3,81 P26THR - 1749557

## Approvals

|                       |       |       |
|-----------------------|-------|-------|
| cULus Recognized      |       |       |
|                       | B     | D     |
| Nominal current $I_N$ | 8 A   | 8 A   |
| Nominal voltage $U_N$ | 150 V | 150 V |

|                       |       |
|-----------------------|-------|
| IECEE CB Scheme       |       |
| Nominal current $I_N$ | 8 A   |
| Nominal voltage $U_N$ | 160 V |

|     |
|-----|
| EAC |
|-----|

## Drawings

Drilling diagram

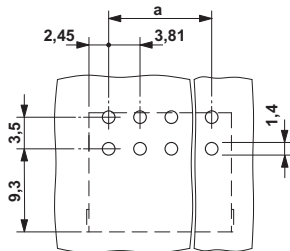

Dimensional drawing

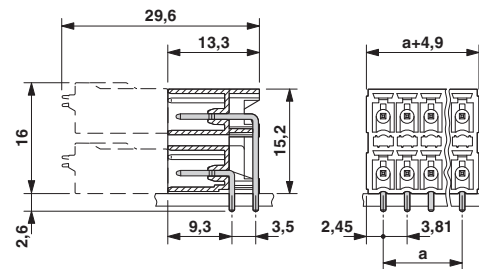

\*)  $\leq 8$ -pos. = 1.3 /  $> 8$ -pos. = 1.4